

**(CCC) Land now forming St Matthews Piece**

1) Any and all details of the Conveyance(s) of December 1891 regarding the acquisition of land now forming St Matthews Piece;  
(2) Any and all details of the documents or other transfer system used when the same land (St Matthews Piece) was gifted by the Cambridge Commons Committee to the Mayor of Cambridge in June 1898

**Response:**

I hope the following will answer your query:

1. *Any and all details of the Conveyance(s) of December 1891 regarding the acquisition of land now forming St Matthews Piece;*

We have made searches of our Legal Services miscellaneous document index and deed store and have not found any information in relation to this property.

We also reviewed the council's property terrier database and found some outline information relating to the parcels of land that make up St Matthews Piece and the surrounding areas. Additional information relating to these areas were also found in a response the council made to an FOI in 2014, which I have used as the basis of the information disclosed.

There are 3 entries from the 19<sup>th</sup> century on the property terrier relating to land that make up St Matthew's Piece and surrounding areas – these are marked on the attached maps and data held on the property terrier.

F/DB00029 – purchased in 1891

F/DB00034 – purchased 1892

F/DB00057 – purchased 1898

We have also made searches for the file reference RWC/PR/SA/1/42 (marked as Covenant on the attached map). This file reference is for a legal file which was destroyed in 2018 in line with the council's retention schedule. The notes on the council's property terrier state *"NOT CITY OWNED BUT THERE IS A COVENANT PREVENTING ANY DEVELOPMENT ON THIS OPEN SPACE Ref: RWC/PR/SA/1/42"*

As the original parcel of land that makes up St Matthews Piece was split between the open space and the land on which the Howard Mallet Centre was built when the northern section was acquired by Cambridgeshire County Council you may wish to request whether any information relating to the land is held by them. Their FOI team can be contacted at [foi@cambridgeshire.gov.uk](mailto:foi@cambridgeshire.gov.uk).

2. Any and all details of the documents or other transfer system used when the

same land (St Matthews Piece) was gifted by the Cambridge Commons Committee to the Mayor of Cambridge in June 1898

In all of the searches outlined above we have not found any reference to the above. This information may have been deposited at the Cambridgeshire County Archive. A number of documents relating to the proceedings of the Council and some committees from the mid-19<sup>th</sup> century to the 1940s are held by the Cambridgeshire County Archive

Details of the County Archives catalogue and arrangements for visiting the archive are available on their website,

<https://www.cambridgeshire.gov.uk/residents/libraries-leisure-culture/archives>

Further queries on this matter should be directed to <a href="mailto:foi@cambridge.gov.uk">foi@cambridge.gov.uk</a>
---





Information Systems  
Team

# St Matthew's Piece City owned land (pink hatched)

© Crown copyright and database right 2014. Ordnance Survey Licence number 100019730.

Date: 03/02/14  
Produced by: Steve Udall  
Section/Department: Informations Systems Team  
Scale: 1:1,250 @ A4



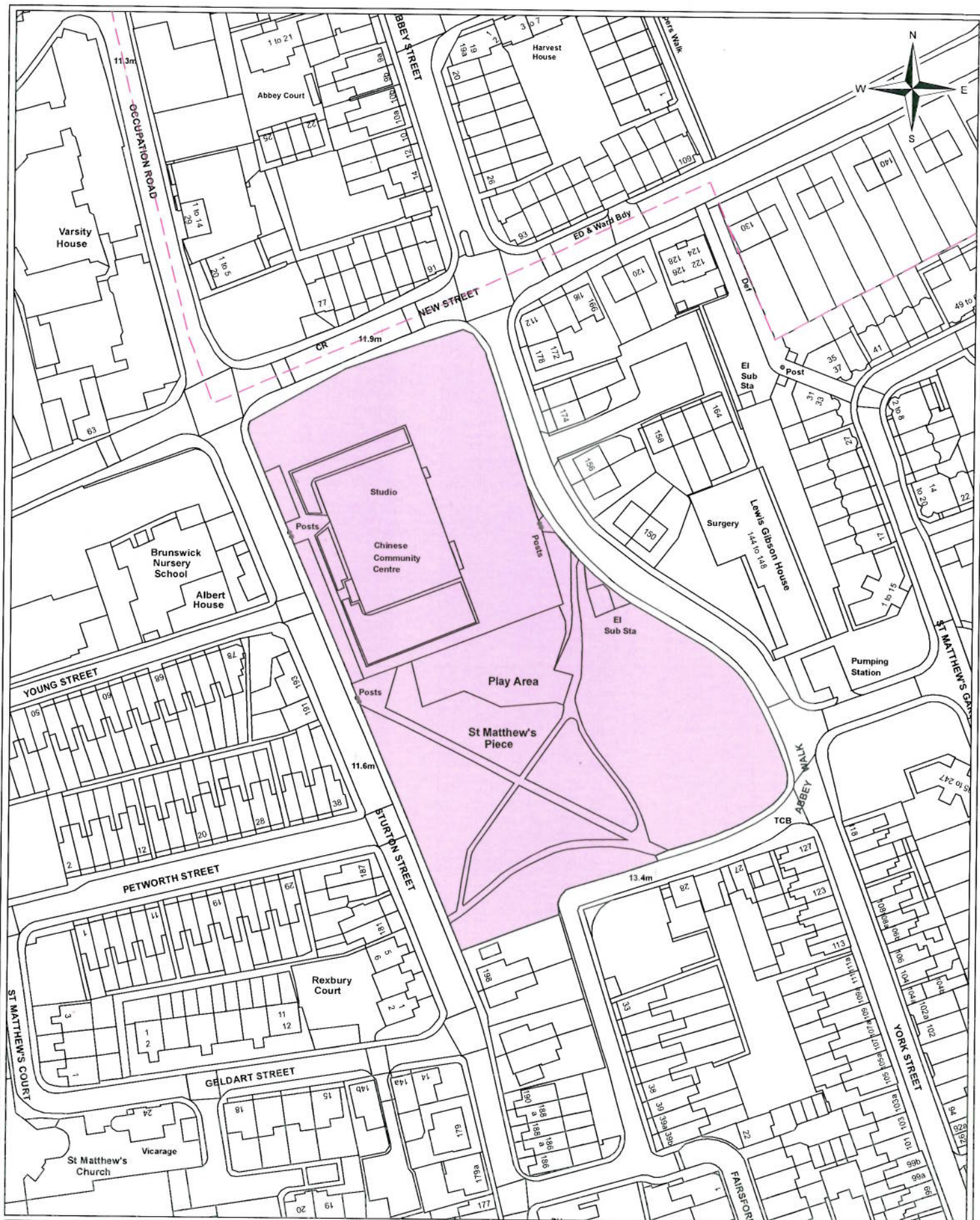

Information Systems  
Team

## Original City owned land at St Matthews Piece Pre 1967

© Crown copyright and database right 2014 Ordnance Survey Licence number 100019730

Date: 03/02/14  
Produced by: Steve Udall  
Section/Department: Informations Systems Team  
Scale: 1:1,250 @ A4



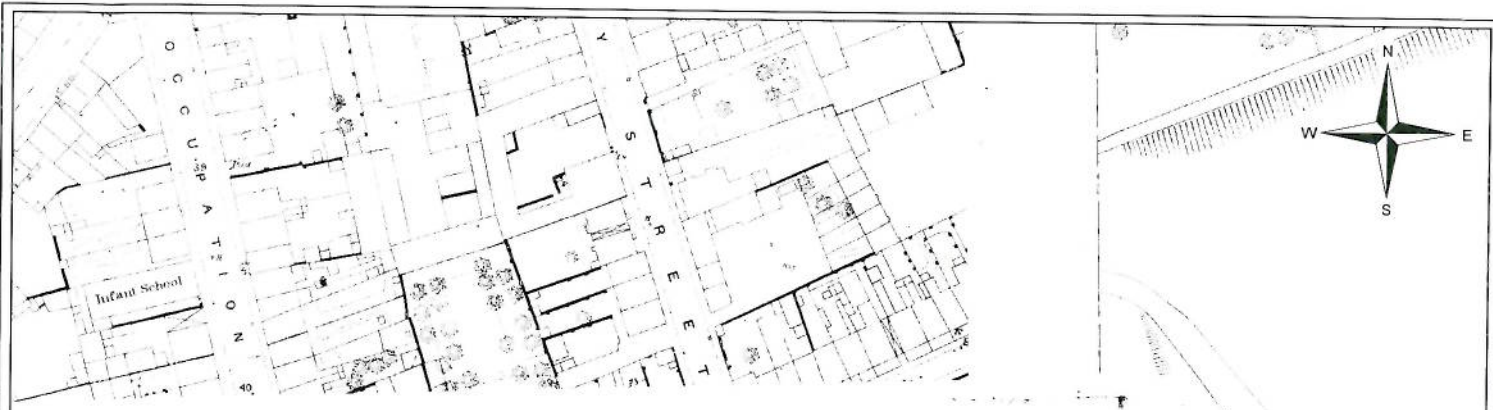

CAMBRIDGESHIRE . CAMBRIDGE SHEET XLVII.2.10.

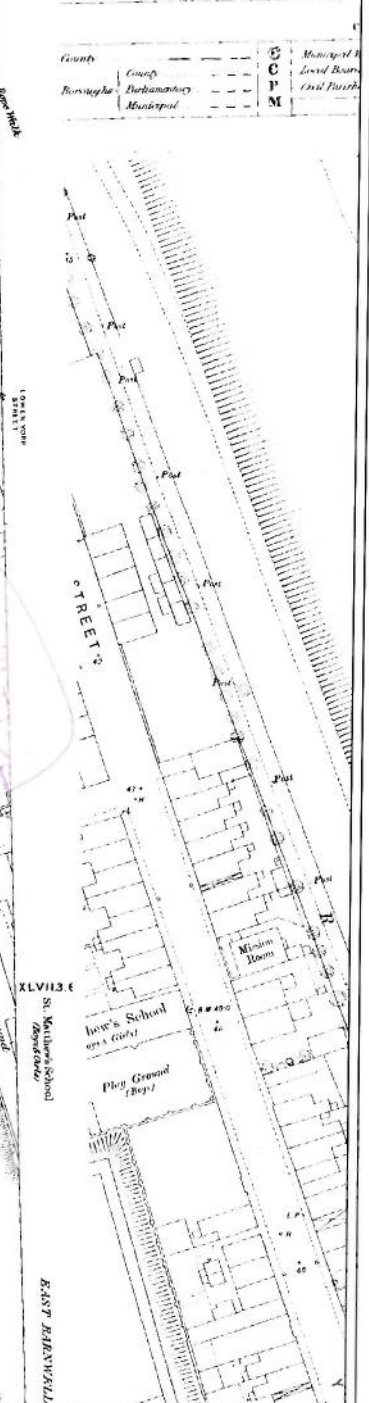

Information Systems  
Team

### St Matthew's Piece 1886 Map Base

© Crown copyright and database right 2014. Ordnance Survey Licence number 100019730.

Date	03/02/14
Produced by	Steve Udall
Section/Department	Informations Systems Team
Scale:	1:1,250 @ A4

# Freehold Full Report - F/DB00029

03 February 2014

## General

LPG Address St Matthews Court, Cambridge

User Address

Quick

Locality PETE - PETERSFIELD WARD

Description Land for recreation ground

Use

Prop Int. FREE - FREEHOLD-VACANT POSS

Family DB00029

Second Ref.

Grouping

Officer

Other Ref.

C & C/9

Acq. Purpose

Purch. Price £ 1,675.00

Power

Purch. Date 02/12/1891

Auth. Date

Committee

Div. Comm.

Hold Comm.

Minute

## Site Details

Land Reg'sty CB290025

Land Leased False

VAT False

Original Site Area

0.68 HA

1.67 Acres

SqM

SqF

Original Floor Area

SqM

SqF

SqM

SqF

Plan No. 50

Vendor

Edward Collier Young

Cambridge

## Map & Insurance

50

TL4658NW

Easting

Northing

Valuers Ref

Responsibility

Payment Pd

Notes

Date

Premium

Lessee Rch

Value

False

**Area & Valuation**

Site Area	HA	Acres	SqM	SqF
Floor Area (INT)	SqM	SqF		
Floor Area (EXT)	SqM	SqF		
Current Usage				
Vacant Notes				
Latest Valuation		Date		
Valuer		Reason		
Valuation Notes				

**Rent Charge**

Rent charge  
payable to

Rent value  
Payment Dates  
Freeholder

Payment Pd

Payment Terms

Asset Ref

One By One

False

Multiple

False

**Ground Rent**

Annual Ground Rent  
Payment Dates  
Commence

Payment Pd

Payment Terms

Expiry

Term

0

0

0

Superior Interest Ref  
Head Interest Ref

Further Acquisition Leases



**ated Addresses****Related Cases**

Case Reference	Status	Case Mask
----------------	--------	-----------

**Title Characteristics**

Characteristic	Reference
----------------	-----------

**Insurance Characteristics**

Characteristic
----------------

**Site Characteristics**

Characteristic
----------------

**Area Breakdown**

Use	Size	UOM	Cost	Notes
-----	------	-----	------	-------

**Diary Codes**

Diary Code	Date 1	Date 2	Date 3	Date 4
------------	--------	--------	--------	--------

**Property Sales References**

Property Sales Ref.	Address	Full / Part
S/DB00029/01	Sturton Street, Cambridge	P

**Remarks**



# Freehold Full Report - F/DB00034

03 February 2014

## General

LPG Address New Street, Cambridge

User Address

Quick

Locality PETE - PETERSFIELD WARD

Description Dwelling & grounds at 82 New Street

Use

Prop Int. FREE - FREEHOLD-VACANT POSS

Family DB00034

Grouping

Other Ref. PW/16

Second Ref.

Officer

Acq. Purpose Extension to Sturton Street

Power

Purch. Price £ 200.00

Purch. Date 09/01/1892

Auth. Date

Committee

Div. Comm.

Hold Comm.

Minute

## Site Details

Land Reg'sty CB290025

Land Leased False

VAT False

Original Site Area

0.08 HA

0.20 Acres

SqM

SqF

Original Floor Area

SqM

SqF

SqM

SqF

Plan No. 50

Vendor

Edward Collier Young

Cambridge

## Map & Insurance

50

TL4658NW

Easting

Northing

Valuers Ref  
Responsibility

Date  
Premium

Lessee Rch  
Value

False

Payment Pd

Notes

**& Valuation**

Site Area	HA	Acres	SqM	SqF
Floor Area (INT)	SqM	SqF		
Floor Area (EXT)	SqM	SqF		
Current Usage				
Vacant Notes				
Latest Valuation		Date		
Valuer		Reason		
Valuation Notes				

**Rent Charge**

Rent charge  
payable to

Rent value  
Payment Dates  
Freeholder

Payment Pd

Payment Terms

Asset Ref

One By One

False

Multiple

Fals

**Ground Rent**

Annual Ground Rent  
Payment Dates  
Commence

Payment Pd

Payment Terms

Expiry

Term

0

0

0

Superior Interest Ref  
Head Interest Ref

Further Acquisition Leases



**ed Addresses****Related Cases**

Case Reference	Status	Case Mask
----------------	--------	-----------

**Title Characteristics**

Characteristic	Reference
----------------	-----------

**Insurance Characteristics**

Characteristic
----------------

**Site Characteristics**

Characteristic
----------------

**Area Breakdown**

Use	Size	UOM	Cost	Notes
-----	------	-----	------	-------

**Diary Codes**

Diary Code	Date 1	Date 2	Date 3	Date 4
------------	--------	--------	--------	--------

**Property Sales References**

Property Sales Ref.	Address	Full / Part
---------------------	---------	-------------

**Remarks**

# Freehold Full Report - F/DB00057

03 February 2014

## General

LPG Address St Matthews Street, Cambridge

User Address

Quick  
Locality PETE - PETERSFIELD WARD Use  
Description Vacant land Prop Int. FREE - FREEHOLD-VACANT POSS

Family DB00057 Grouping Other Ref. C & C/12  
Second Ref. Officer

Acq. Purpose Addition to recreation ground Power  
Purch. Price £ 800.00 Purch. Date 24/05/1898 Auth. Date

Committee Minute  
Div. Comm.  
Hold Comm.

## Site Details

Land Reg'sty CB290025 Land Leased False VAT False

Original Site Area	0.06 HA	0.14 Acres	SqM	SqF
Original Floor Area	SqM	SqF	SqM	SqF

Plan No. 50

Vendor  
Robert Smith  
Hanley House  
Lower Sturton Street  
Cambridge

## Map & Insurance

50 TL4658NW

Easting Northing

Valuers Ref Date Lessee Rch False  
Responsibility Premium Value  
Payment Pd  
Notes



**Area & Valuation**

Site Area	HA	Acres	SqM	SqF
Floor Area (INT)	SqM	SqF		
Floor Area (EXT)	SqM	SqF		
Current Usage				
Vacant Notes				
Latest Valuation		Date		
Valuer		Reason		
Valuation Notes				

**Rent Charge**

Rent charge  
payable to

Rent value  
Payment Dates

Payment Pd

Payment Terms

Freeholder

Asset Ref

One By One

False

Multiple

Fals

**Ground Rent**

Annual Ground Rent

Payment Dates

Commence

Payment Pd

Payment Terms

Expiry

Term

0

0

0

Superior Interest Ref

Head Interest Ref

Further Acquisition Leases

**Related Addresses****Related Cases**

Case Reference	Status	Case Mask
----------------	--------	-----------

**Title Characteristics**

Characteristic	Reference
----------------	-----------

**Insurance Characteristics**

Characteristic
----------------

**Site Characteristics**

Characteristic
----------------

**Area Breakdown**

Use	Size	UOM	Cost	Notes
-----	------	-----	------	-------

**Diary Codes**

Diary Code	Date 1	Date 2	Date 3	Date 4
------------	--------	--------	--------	--------

**Property Sales References**

Property Sales Ref.	Address	Full / Part
---------------------	---------	-------------

**Remarks**