

CAMBRIDGE CITY COUNCIL

The City of Cambridge (Off-Street Parking Places) (Amendment No. 3) Order 2019

ISSUE 01

Operative from 1 April 2019 THE CITY OF CAMBRIDGE (OFF-STREET PARKING PLACES) (AMENDMENT NO. 3) ORDER 2019

This Order is made by Cambridge City Council in exercise of their powers under Sections 32, 33, 35 and 124 and Part IV of Schedule 9 of the Road Traffic Regulation Act 1984 and of all other enabling powers. Cambridge City Council makes this Order in respect of all parking places referred to in this Order. Cambridge City Council makes this Order with the consent of Cambridgeshire County Council in accordance with Section 39(3) of the 1984 Act. The Chief Officer of Police has been consulted about this Order in accordance with paragraph 20 of Schedule 9 to the 1984 Act.

1. This Order shall come into operation for all purposes on the 1 April 2019 and may be cited as The City of Cambridge (Off-Street Parking Places) (Amendment No. 3) Order 2019.
2. The City of Cambridge (Off-Street Parking Places) Order 2016 (the original Order) shall be amended as follows:
 - (1) Insert into Schedule 4 of the Order of 2016 the rows included in the table in Schedule 1 of this Order.
 - (2) Insert into Schedule 3 of the Order of 2016 the rows included in the table in Schedule 2 of this Order.
 - (3) Insert into Schedule 11 of the Order of 2016 the rows included in the table in Schedule 3 of this Order.
 - (4) Insert into Schedule 9 of the Order of 2016 the rows included in the table in Schedule 4 of this Order.
 - (5) Insert into Schedule 5 of the Order of 2016 the rows included in the table in Schedule 5 of this Order.
 - (6) Insert into Schedule 10 of the Order of 2016 the rows included in the table in Schedule 6 of this Order.
 - (7) Substitute the tables in Schedule 7 of the Order of 2016 with the table in Schedule 7 of this Order to reflect the new tariffs and charging periods applicable from the date this Order comes into operation.
 - (8) Substitute the tables in Schedule 6 of the Order of 2016 with the table in Schedule 8 of this Order to reflect the new tariffs and charging periods applicable from the date this Order comes into operation.
 - (9) Substitute the table in Schedule 8 – Part 1 of the Order of 2016 with the table in Schedule 9 of this Order to reflect the new tariffs applicable from the date this Order comes into operation.
 - (10) Substitute the table in Schedule 8 – Part 2 of the Order of 2016 with the table in Schedule 10 of this Order to reflect the new tariffs applicable from the date this Order comes into operation.

GIVEN under the COMMON SEAL

of CAMBRIDGE CITY COUNCIL

this day of 2019

in the presence of:

Head of Legal Services

Schedule 1

Designated free car parks and parking places

| Column 1 | Column 2 | Column 3 | Column 4 | Column 5 |
|-------------------------------------|-------------------------|--|-------------------------------------|------------------|
| Designated Car Park or Parking Area | Plan of designated area | Operational hours / Maximum Stay | Position in which Vehicles may Wait | Class of Vehicle |
| Alex Wood Road car park | Schedule 9, Plan 36 | Monday – Saturday 9am - 5pm maximum stay 4 hours, no return within 2 hours for the pink shaded area in Plan 36 | Note 1 | Note 2 |
| Jedburgh Court car park | Schedule 9, Plan 39 | All hours on all days, no maximum stay | Note 1 | Note 2 |

Note 1: Where parking bays are marked, wholly within a parking bay as indicated by the markings on the surface, otherwise so as not to cause obstruction to any other vehicles trying to gain access to or egress from the parking area, or any parking space within a parking area.

Note 2: Private motor vehicles, motorcycles, motorcycle combinations and goods vehicles of 1.5 tonnes or less unladen weight.

Schedule 2

Permit holder off-street parking areas and valid permits

| Column 1 | Column 2 | Column 3 | Column 4 | Column 5 | Column 6 |
|--------------------------------|--------------------|---------------------------------|---|--|------------------|
| Designated Permit Parking Area | Plan | Controlled Hours / Maximum Stay | Valid Permits / Parking | Conditions (Subject to the provisions of this Order) | Class of vehicle |
| James Street car park | Schedule 9 Plan 37 | At all times | JS resident and visitor permit holders only | Parked wholly within marked bays. | Note 1 |
| Stanton House car park, | Schedule 9 Plan 38 | At all times | SH resident and visitor permit holders only | Parked wholly within marked bays. | Note 1 |

Note 1: Private motor vehicles, motorcycles, motorcycle combinations and goods vehicles of 1.5 tonne or less unladen weight.

Schedule 3

Off-street parking valid permits and permit eligibility

| Column 1 | Column 2 | Column 3 |
|---|---|---------------------------------|
| Type of permit | Valid for | Those eligible for permits |
| Stanton House resident and visitor permits only | Stanton House car park, off Christchurch Street | Residents of 1-33 Stanton House |
| James Street resident and visitor permits only | James Street car park, off James Street | Residents of 5-12 James Street |

Schedule 4

Plans of off-street parking places attached to this Order

| Plan No. | Designated car parks / parking places |
|----------|---|
| 36 | Alex Wood Road car park |
| 37 | Stanton House car park, off Christchurch Street |
| 38 | James Street car park, off James Street |
| 39 | Jedburgh Court car park |

Schedule 5

Designated garage forecourt and access road parking places

| Column 1 | Column 2 | Column 3 | Column 4 |
|---|--|--------------------------|---|
| Designated garage forecourt parking areas: | Plan of designated parking areas: | Permitted parking | Conditions (Subject to the provisions of this Order) |
| Gunhild Court | Schedule 10, Plan 120 | Note 1 | Note 2 |
| Bermuda Terrace | Schedule 10, Plan 121 | Note 1 | Note 2 |

Note 1: Within the contracted garage space and any marked bays only.

Note 2: No parking on access road double yellow lines or any hatch markings, being for the purposes of this Order restricted areas.

Schedule 6

Plans of designated off-street garage forecourt and access roads car parks attached to this Order

| Plan No. | Designated off-street garage forecourt car parks |
|----------|--|
| 120 | Gunhild Court |
| 121 | Burmuda Terrace |

Schedule 7

Pay-and display charging hours and parking charges

| Lammas Land Car Park | | | | |
|--|---|-----------------------------------|--------------------------------|------------------------------|
| | Summer (1 April - 31 October) | | Winter (1 November - 31 March) | |
| Waiting Time/Period | Monday to Friday 8am-10pm | Saturday & Sunday 8am- 10pm | Monday to Friday 8am-4pm | Saturday & Sunday 8am-4pm |
| Up to 2 hours | £2.00 | £2.00 | £2.00 | £2.00 |
| Up to 4 hours | £5.00 | £4.80 | £5.00 | £4.80 |
| Up to 5 hours | £10.00 | £9.00 | £10.00 | £9.00 |
| Up to 8 hours | £20.00 | n/a | £20.00 | n/a |
| Car Club Permit Holders | Free if parking bays are marked for Car Club Permit Holders (cost of permits to Car Club Operators - see Schedule 8 Part 2) | | | |
| Disabled Badge Holders | First 3 hours free | | | |
| Electric Charging | Drivers of electrically powered motor vehicles and motorcycles are permitted 2 hours free charging whilst in an authorised and designated electric vehicle charging/parking bay. If an electronically powered vehicle is parked longer than the maximum permitted period for recharging in a designated electric vehicle parking bay the driver commits an offence. | | | |
| Maximum Time Limit during Charging Hours | Max stay Monday to Friday 8 hours. Saturday and Sunday 5 hours. All days no return within 1 hour. | | | |
| Special offers, trial charges, pre booking and closures for special events will supplement the tariffs above on various car parks as advertised on various car parks as advertised locally from time to time. Drivers for parcel collection and drop off will be charged at usual car park rates. | | | | |

Schedule 7

| Adam & Eve Street Car Park | | | |
|---|---|------------------------|----------------------|
| Waiting Time/Period | Monday to Friday 8am-7pm | Saturdays 9am - 7pm | Sunday 10am - 5pm |
| Up to 20 minutes | £0.80 | £0.80 | £0.80 |
| Up to 40 minutes | £1.60 | £1.60 | £1.60 |
| Up to 1 hour | £2.40 | £2.40 | £2.40 |
| Up to 1 hour 20 minutes | £3.20 | £3.20 | £3.20 |
| Up to 1 hour 40 minutes | £4.00 | £4.00 | £4.00 |
| Up to 2 hours | £4.80 | £4.80 | £4.80 |
| Evening and overnight | All other hours free | | |
| Season Tickets | Not applicable | | |
| Car Club Permit Holders | Free if parking bays are marked for Car Club Permit Holders (Cost of permits to Car Club Operators - See Schedule 8 Part 2) | | |
| Disabled Badge Holders | First 2 hours free | | |
| Maximum Time Limit during Charging Hours | 2 hours with no return within 1 hour | | |
| <p>Special offers, trial charges, pre booking and closures for special events will supplement the tariffs above on various car parks as advertised on various car parks as advertised locally from time to time.</p> <p>Drivers for parcel collection and drop off will be charged at usual car park rates.</p> | | | |

Schedule 7

| Gwydir Street car park | | | | Abbey Road/Riverside Car Park | | |
|--|--|----------------------|--------|--|------------------------|--------|
| Waiting Time/Period | Monday to Friday 8am-7pm | Saturday 9am- 7pm | Sunday | Monday to Friday 8am-7pm | Saturday 9am to 7pm | Sunday |
| Up to 30 minutes | £0.90 | £0.90 | Free | £0.90 | £0.90 | Free |
| Up to 60 minutes | £1.80 | £1.80 | | £1.80 | £1.80 | |
| Up to 90 minutes | £2.70 | £2.70 | | £2.70 | £2.70 | |
| Up to 2 hours | £3.60 | £3.60 | | £3.60 | £3.60 | |
| Evening and overnight | All other hours free | | | All other hours free | | |
| Season Tickets | Not applicable | | | Not applicable | | |
| Car Club Permit Holders | Free if parking bays are marked for Car Club Permit Holders (Cost of permits to Car Club Operators - See Schedule 8 Part 2) | | | Free if parking bays are marked for Car Club Permit Holders (Cost of permits to Car Club Operators - See Schedule 8 Part 2) | | |
| Disabled Badge Holders | First 2 hours free | | | First 2 hours free | | |
| Maximum Time Limit during Charging Hours | 2 hours with no return within 1 hour | | | 8 hours with no return within 1 hour | | |
| Special offers, trial charges, pre booking and closures for special events will supplement the tariffs above on various car parks as advertised on various car parks as advertised locally from time to time. Drivers for parcel collection and drop off will be charged at usual car park rates. | | | | | | |

Schedule 7

| Castle Hill Car Park | | | | |
|---|---|------------------|-----------------|---|
| Waiting Time/Period | Monday to Friday 8am-10pm | Saturday 9am-7pm | Sunday 10am-5pm | 7 day weekly ticket covering Mon-Fri 8am-7pm Sat 9am-7pm Sun 10am-5pm |
| Up to 2 hours | £2.60 | £2.60 | £4.10 | £35.80 |
| 2-4 hours | £4.90 | £4.90 | | |
| over 4 hours | £8.20 | £8.20 | | |
| Evening and overnight | All other hours free | | | |
| Season Tickets | Not applicable | | | |
| Car Club Permit Holders | Free if parking bays are marked for Car Club Permit Holders (Cost of permits to Car Club Operators - See Schedule 8 Part 2) | | | |
| Disabled Badge Holders | First 3 hours free | | | |
| Electric Charging | Drivers of electrically powered motor vehicles and motorcycles are permitted 2 hours free charging whilst in an authorised and designated electric vehicle charging/parking bay. If an electronically powered vehicle is parked longer than the maximum permitted period for recharging in a designated electric vehicle parking bay the driver commits an offence. | | | |
| <p>Special offers, trial charges, pre booking and closures for special events will supplement the tariffs above on various car parks as advertised on various car parks as advertised locally from time to time.</p> <p>Drivers for parcel collection and drop off will be charged at usual car park rates.</p> | | | | |

Schedule 8

Pay-on-foot charging hours and parking charges

| Grafton East Car Park | | | | | |
|--|---|--|---|---|---|
| Waiting Time/Period | Monday to Friday 8am-7pm (Vehicles arriving 8am-10am) | Monday to Friday 8am-7pm (Vehicles arriving 10am-7pm) | Saturdays 11am– 7pm & Sundays 11am-5pm (Vehicles arriving 11am-1pm) | Saturdays 9am-7pm (Vehicles arriving 9am-11am, 1pm- 7pm) | Sundays 10am-5pm (Vehicles arriving 10am-11am, 1pm- 5pm) |
| Up to 1 hour | £2.80 | £2.30 | £2.80 | £2.30 | £2.30 |
| Up to 2 hours | £4.80 | £3.80 | £4.80 | £3.80 | £3.80 |
| Up to 3 hours | £7.40 | £5.90 | £7.40 | £5.90 | £5.90 |
| Up to 4 hours | £11.70 | £9.70 | £11.70 | £9.70 | £9.70 |
| Up to 5 hours | £20.40 | £17.90 | £20.40 | £17.90 | £17.90 |
| Over 5 hours | £28.30 | £25.30 | £28.30 | £25.30 | £25.30 |
| Evenings and overnight | All other hours 80p per hour | | | | |
| Season Business Permits | See Schedule 8 Part 1 | | | | |
| Motorcycles | Free motorcycle parking available in designated motorcycle parking area | | | | |
| Disabled Badge Holders | First 3 hours free for those entering between 8am-8pm on verification of their Disabled Person's Badge or the badge of the person being transported in their vehicle at the relevant time | | | | |
| Electric Charging | Drivers of electrically powered motor vehicles and motorcycles are permitted 3 hours free charging whilst parking in an authorised and designated electric vehicle charging/parking bay. If an electronically powered vehicle is parked longer than the maximum permitted period for recharging in a designated electric vehicle parking bay the driver commits an offence. | | | | |
| Special offers, trial charges, pre booking and closures for special events will supplement the tariffs above on various car parks as advertised locally from time to time. Drivers for parcel collection and drop off will be charged usual car park rates. | | | | | |

Schedule 8

| Grafton West Car Park | | | | | |
|--|---|--|---|---|--|
| Waiting Time/Period | Monday to Friday 8am-7pm (Vehicles arriving 8am-10am) | Monday to Friday 8am-7pm (Vehicles arriving 10am-7pm) | Saturdays 11am– 7pm & Sundays 11am-5pm (Vehicles arriving 11am-1pm) | Saturdays 9am- 7pm (Vehicles arriving 9am-11am, 1pm- 7pm) | Sundays 10am- 5pm (Vehicles arriving 10am-11am, 1pm-5pm) |
| Up to 1 hour | £2.80 | £2.30 | £2.80 | £2.30 | £2.30 |
| Up to 2 hours | £4.80 | £3.80 | £4.80 | £3.80 | £3.80 |
| Up to 3 hours | £7.40 | £5.90 | £7.40 | £5.90 | £5.90 |
| Up to 4 hours | £11.70 | £9.70 | £11.70 | £9.70 | £9.70 |
| Up to 5 hours | £20.40 | £17.90 | £20.40 | £17.90 | £17.90 |
| Over 5 hours | £28.30 | £25.30 | £28.30 | £25.30 | £25.30 |
| Evenings and overnight | All other hours 80p per hour | | | | |
| Season Business Permits | See Schedule 8 Part 1 | | | | |
| Motorcycles | Free motorcycle parking available in designated motorcycle parking area | | | | |
| Disabled Badge Holders | First 3 hours free for those entering between 8am-8pm on verification of their Disabled Person's Badge or the badge of the person being transported in their vehicle at the relevant time | | | | |
| Brunswick Resident Parking Permit Holders and Kite Resident Parking Permit Holders | After submitting a completed prescribed application form and tendering the prescribed fee resident parking permit holders may park in the car park after 6.30pm Monday to Friday and exiting before 8.30am the following day or where their vehicle enters Daily Parking Charges apply to all other entry and/or exit times | | | | |
| Electric Charging | Drivers of electrically powered motor vehicles and motorcycles are permitted 3 hours free charging whilst parking in an authorised and designated electric vehicle charging/parking bay. If an electronically powered vehicle is parked longer than the maximum permitted period for recharging in a designated electric vehicle parking bay the driver commits an offence. | | | | |
| Special offers, trial charges, pre booking and closures for special events will supplement the tariffs above on various car parks as advertised locally from time to time. Drivers for parcel collection and drop off will be charged usual car park rates. | | | | | |

Schedule 8

| Grand Arcade Car Park | | | | | |
|--|---|--|---|---|---|
| Waiting Time/Period | Monday to Friday 8am-7pm (Vehicles arriving 8am-10am) | Monday to Friday 8am-7pm (Vehicles arriving 10am-7pm) | Saturdays 11am– 7pm & Sundays 11am-5pm (Vehicles arriving 11am-1pm) | Saturdays 9am- 7pm (Vehicles arriving 9am-11am, 1pm- 7pm) | Sundays 10am- 5pm (Vehicles arriving 10am-11am, 1pm- 5pm) |
| Up to 1 hour | £3.00 | £2.50 | £3.00 | £2.50 | £2.50 |
| Up to 2 hours | £5.90 | £4.90 | £5.90 | £4.90 | £4.90 |
| Up to 3 hours | £8.80 | £7.30 | £8.80 | £7.30 | £7.30 |
| Up to 4 hours | £12.70 | £10.70 | £12.70 | £10.70 | £10.70 |
| Up to 5 hours | £23.00 | £20.50 | £23.00 | £20.50 | £20.50 |
| Over 5 hours | £29.40 | £26.40 | £29.40 | £26.40 | £26.40 |
| Evenings and overnight | All other hours £1.20 per hour | | | | |
| Season Business Permits | Not applicable | | | | |
| Motorcycles | Free motorcycle parking available in designated motorcycle parking area | | | | |
| Disabled Badge Holders | First 3 hours free for those entering between 8am-8pm on verification of their Disabled Person's Badge or the badge of the person being transported in their vehicle at the relevant time | | | | |
| Electric Charging | Drivers of electrically powered motor vehicles and motorcycles are permitted 3 hours free charging whilst parking in an authorised and designated electric vehicle charging/parking bay. If an electronically powered vehicle is parked longer than the maximum permitted period for recharging in a designated electric vehicle parking bay the driver commits an offence. | | | | |
| Special offers, trial charges, pre booking and closures for special events will supplement the tariffs above on various car parks as advertised locally from time to time. Drivers for parcel collection and drop off will be charged usual car park rates. | | | | | |

Schedule 8

| Park Street Car Park | | | | | |
|--|---|--|---|---|---|
| Waiting Time/Period | Monday to Friday 8am-7pm (Vehicles arriving 8am-10am) | Monday to Friday 8am-7pm (Vehicles arriving 10am-7pm) | Saturdays 11am- 7pm & Sundays 11am-5pm (Vehicles arriving 11am-1pm) | Saturdays 9am- 7pm (Vehicles arriving 9am-11am, 1pm- 7pm) | Sundays 10am- 5pm (Vehicles arriving 10am-11am, 1pm- 5pm) |
| Up to 1 hour | £2.80 | £2.30 | £2.80 | £2.30 | £2.30 |
| Up to 2 hours | £4.80 | £3.80 | £4.80 | £3.80 | £3.80 |
| Up to 3 hours | £7.40 | £5.90 | £7.40 | £5.90 | £5.90 |
| Up to 4 hours | £11.70 | £9.70 | £11.70 | £9.70 | £9.70 |
| Up to 5 hours | £20.40 | £17.90 | £20.40 | £17.90 | £17.90 |
| Over 5 hours | £28.30 | £25.30 | £28.30 | £25.30 | £25.30 |
| Evenings and overnight | All other hours 80p per hour | | | | |
| Season Business Permits | See Schedule 8 Part 1 | | | | |
| Motorcycles | Free motorcycle parking available in designated motorcycle parking area | | | | |
| Disabled Badge Holders | First 3 hours free for those entering between 8am-8pm on verification of their Disabled Person's Badge or the badge of the person being transported in their vehicle at the relevant time | | | | |
| Electric Charging | Drivers of electrically powered motor vehicles and motorcycles are permitted 3 hours free charging whilst parking in an authorised and designated electric vehicle charging/parking bay. If an electronically powered vehicle is parked longer than the maximum permitted period for recharging in a designated electric vehicle parking bay the driver commits an offence. | | | | |
| Special offers, trial charges, pre booking and closures for special events will supplement the tariffs above on various car parks as advertised locally from time to time. Drivers for parcel collection and drop off will be charged usual car park rates. | | | | | |

Schedule 8

| Queen Anne Terrace Car Park | | | | | |
|--|---|--|--|--|--|
| Waiting Time/Period | Monday to Friday 8am-7pm (Vehicles arriving 8am-10am) | Monday to Friday 8am-7pm (Vehicles arriving 10am-7pm) | Saturdays 11am-7pm & Sundays 11am-5pm (Vehicles arriving 11am-1pm) | Saturdays 9am-7pm (Vehicles arriving 9am-11am, 1pm-7pm) | Sundays 10am-5pm (Vehicles arriving 10am-11am, 1pm-5pm) |
| Up to 1 hour | £2.10 | £1.60 | £2.10 | £1.60 | £1.60 |
| Up to 2 hours | £4.20 | £3.20 | £4.20 | £3.20 | £3.20 |
| Up to 3 hours | £5.90 | £4.40 | £5.90 | £4.40 | £4.40 |
| Up to 4 hours | £7.20 | £5.20 | £7.20 | £5.20 | £5.20 |
| Up to 5 hours | £9.40 | £6.90 | £9.40 | £6.90 | £6.90 |
| Up to 6 hours | £13.50 | £10.50 | £13.50 | £10.50 | £10.50 |
| Over 6 hours | £17.50 | £14.00 | £17.50 | £14.00 | £14.00 |
| Evenings and overnight | All other hours 80p per hour | | | | |
| Season Business Permits | See Schedule 8 Part 1 | | | | |
| Motorcycles | Free motorcycle parking available in designated motorcycle parking area | | | | |
| Disabled Badge Holders | First 3 hours free for those entering between 8am-8pm on verification of their Disabled Person's Badge or the badge of the person being transported in their vehicle at the relevant time | | | | |
| Electric Charging | Drivers of electrically powered motor vehicles and motorcycles are permitted 3 hours free charging whilst parking in an authorised and designated electric vehicle charging/parking bay. If an electronically powered vehicle is parked longer than the maximum permitted period for recharging in a designated electric vehicle parking bay the driver commits an offence. | | | | |
| Special offers, trial charges, pre booking and closures for special events will supplement the tariffs above on various car parks as advertised locally from time to time. Drivers for parcel collection and drop off will be charged usual car park rates. | | | | | |

Schedule 9

Season Ticket Charge

| Park Street – Queen Anne Terrace – Grafton East (Note 1)– Grafton West Car Parks | | | |
|---|--------------------------------|---|-----------------|
| Column 1 | Column 2 | Column 3 | Column 4 |
| Type of Business Season Ticket | Quarterly fee inclusive of VAT | 20% discount for low emission (Group A vehicles – See note 3) | Discounted fee |
| “Night Owl” 7 days 5pm-8am (one car park – See note 2) | £230 | -£46 | £184 |
| 24/7 Premium (Grafton car parks, Park Street, Queen Anne Terrace) | £890 | -£178 | £712 |
| Monday-Friday 24-hour access (one car park – See note 2) | £680 | -£136 | £544 |
| Monday-Friday 8am-6pm (one car park – See note 2) | £540 | -£108 | £432 |

Schedule 10

Car Club Permit Charges

| Column 1 | Column 2 | Column 3 | Column 4 |
|---|--------------------------------|--|--|
| Type of permit | Quarterly fee inclusive of VAT | Valid Period (Subject to the provisions of this Order) | Valid locations |
| Approved car club operator's car club vehicle permit. | £800 | 3 months from date of issue | Adam and Eve Street car park, car club permit holder marked bays only. |
| Approved car club operator's car club vehicle permit. | £125 | 3 months from date of issue | Alex Wood car park, car club permit holder marked bays only. |
| Approved car club operator's car club vehicle permit. | £440 | 3 months from date of issue | Castle Hill car park, car club permit holder marked bays only. |
| Approved car club operator's car club vehicle permit. | £125 | 3 months from date of issue | Cherry Hinton Hall car park, car club permit holder marked bays only. |
| Approved car club operator's car club vehicle permit. | £200 | 3 months from date of issue | Great Eastern Street car park, car club permit holder marked bays only. |
| Approved car club operator's car club vehicle permit. | £275 | 3 months from date of issue | Gwydir Street car park, car club permit holder marked bays only. |
| Approved car club operator's car club vehicle permit. | £125 | 3 months from date of issue | Access Road to Gwydir Enterprise Centre car park, car club permit holder marked bays only. |
| Approved car club operator's car club vehicle permit. | £125 | 3 months from date of issue | Hobson Square car park, car club permit holder marked bays only. |
| Approved car club operator's car club vehicle permit. | £125 | 3 months from date of issue | Jedburgh Court car park, car club permit holder marked bays only. |
| Approved car club operator's car club vehicle permit. | £440 | 3 months from date of issue | Lammas Land car park, car club permit holder marked bays only. |
| Approved car club operator's car club vehicle permit. | £125 | 3 months from date of issue | Petworth Street car park, car club permit holder marked bays only. |
| Approved car club operator's car club vehicle permit. | £170 | 3 months from date of issue | Riverside car park, car club permit holder marked bays only. |
| Approved car club operator's car club vehicle permit. | £125 | 3 months from date of issue | Sleaford Street/Ainsworth Street car park, car club permit holder marked bays only. |

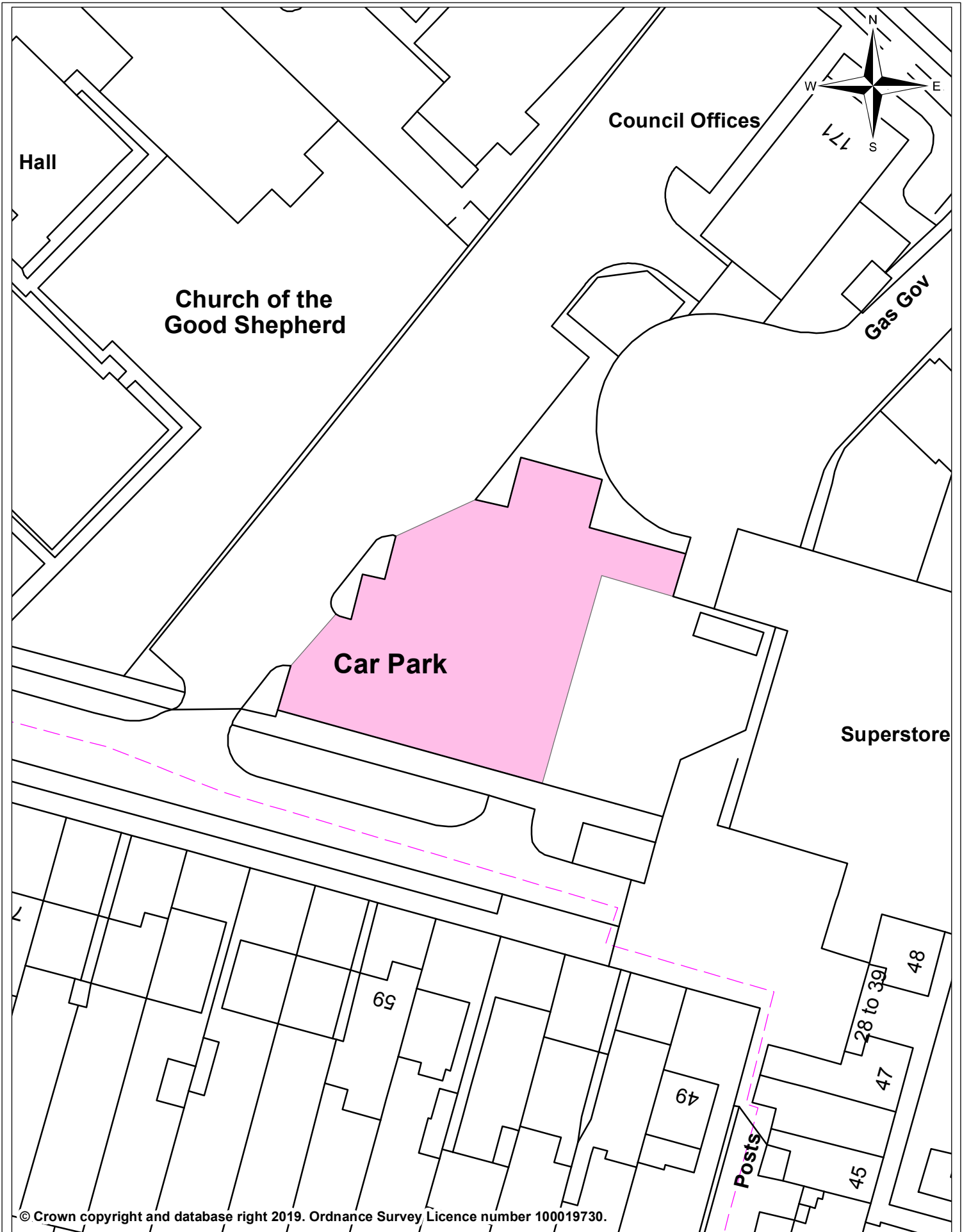

© Crown copyright and database right 2019. Ordnance Survey Licence number 100019730.



**Arbury Court Parking
Alex Wood Road Car Park
Schedule 9 Plan No. 36**

| | |
|---------------------|---------------------------|
| Date: | 14 February 2019 |
| Produced by: | 3C Shared Services |
| Section/Department: | Spatial Team |
| Scale: | 1:500 @ A4 |

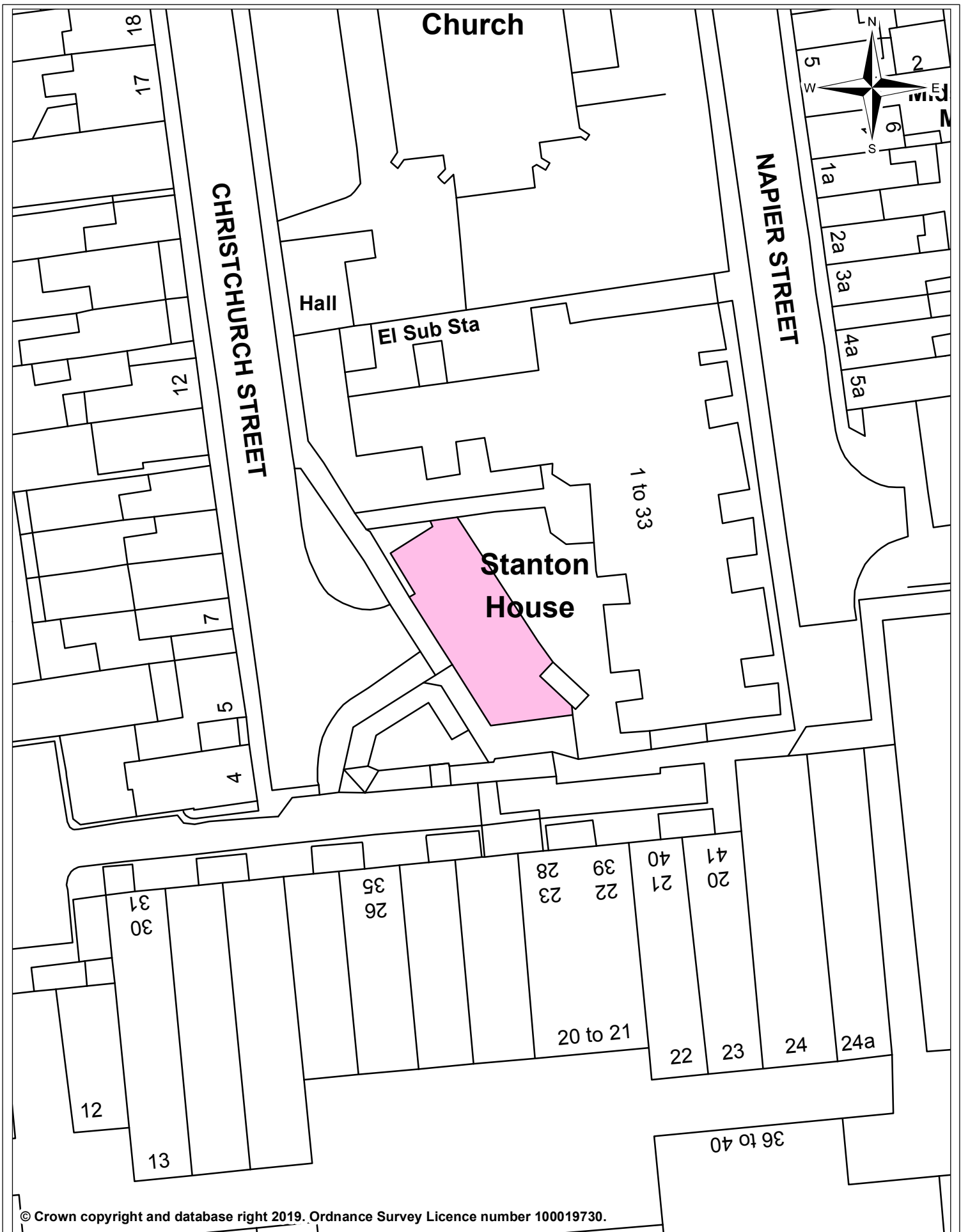

© Crown copyright and database right 2019. Ordnance Survey Licence number 100019730.

Stanton House Car Park
Christchurch Street
Schedule 9 Plan No. 37

Date: 14 February 2019
 Produced by: **3C** Shared Services
 Section/Department: Spatial Team
 Scale: 1:500 @ A4



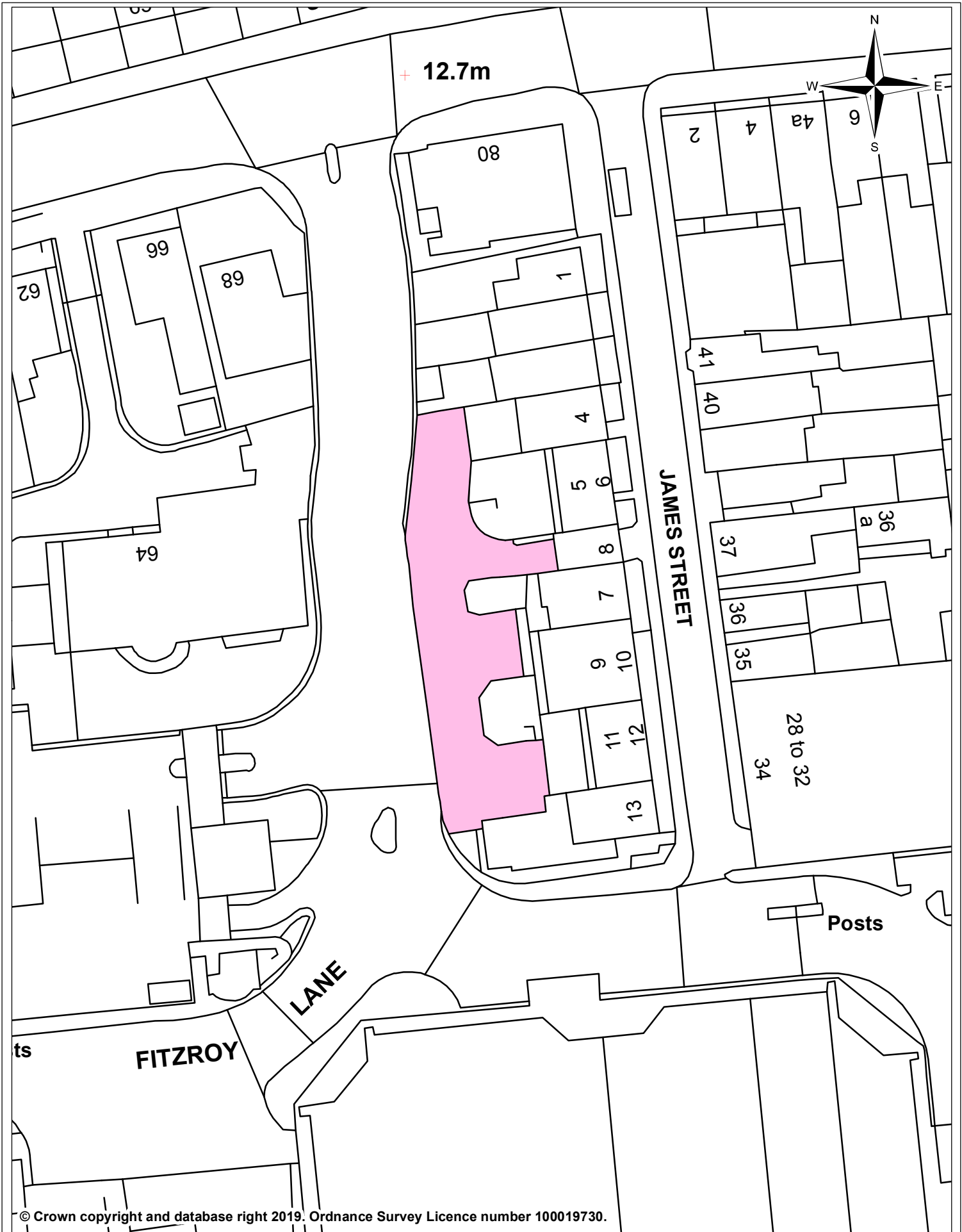

© Crown copyright and database right 2019. Ordnance Survey Licence number 100019730.

James Street Car Park Schedule 9 Plan No. 38

| | |
|---------------------|------------------|
| Date: | 14 February 2019 |
| Produced by: | |
| Section/Department: | Spatial Team |
| Scale: | 1:500 @ A4 |



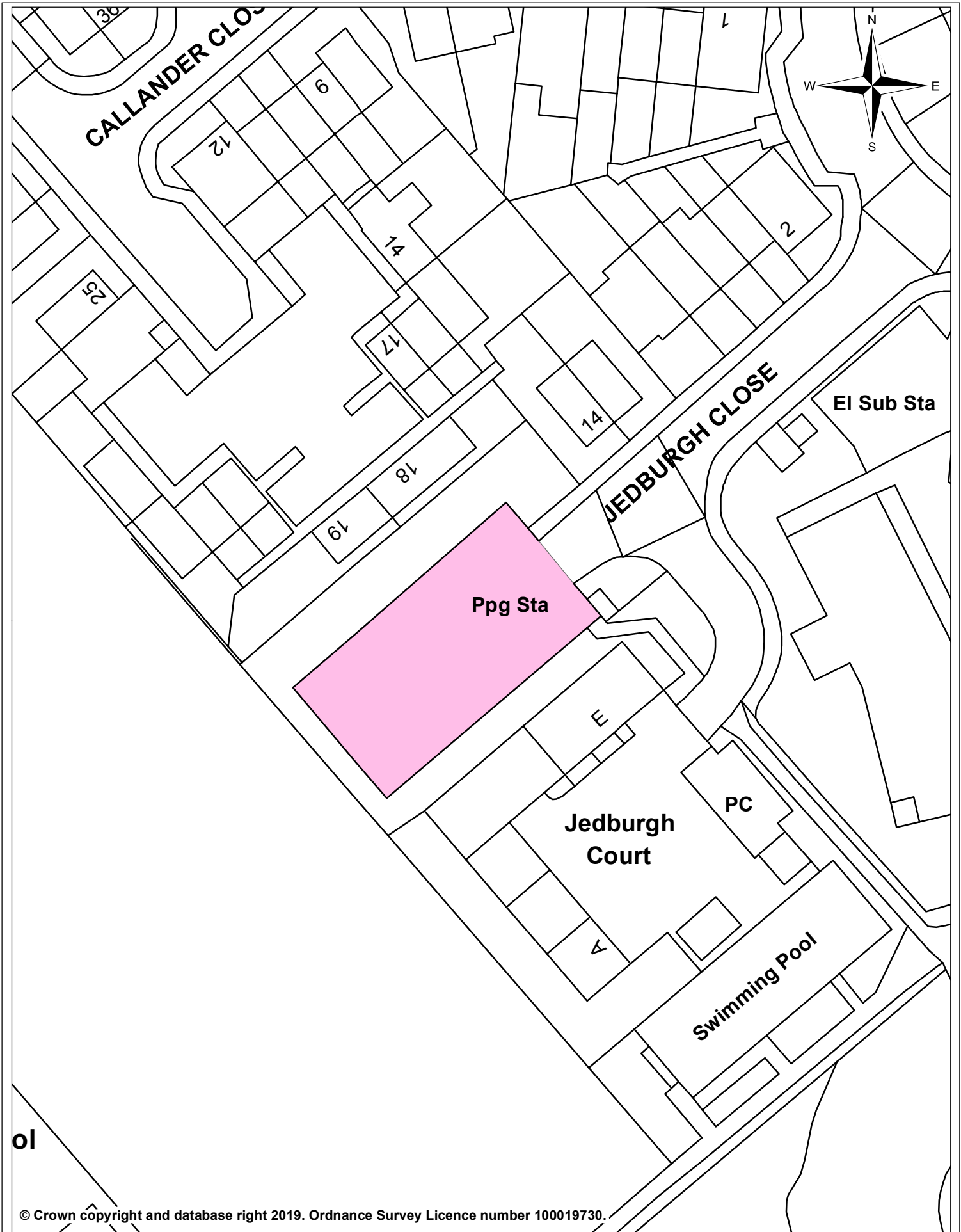

© Crown copyright and database right 2019. Ordnance Survey Licence number 100019730.



Jedburgh Court Car Park Schedule 9 Plan No. 39

| | |
|---------------------|--------------------|
| Date: | 14 February 2019 |
| Produced by: | 3C Shared Services |
| Section/Department: | Spatial Team |
| Scale: | 1:500 @ A4 |

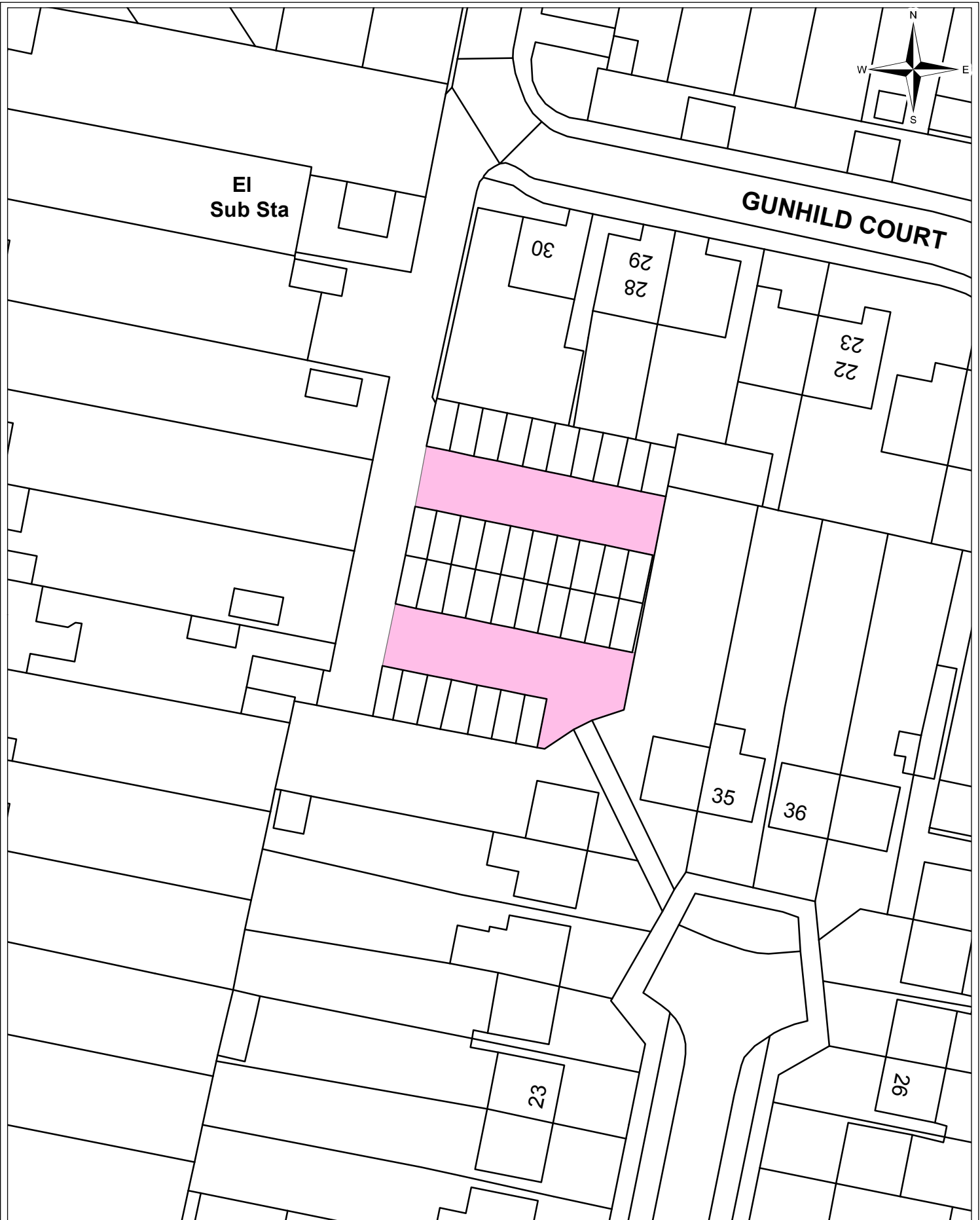

Information Systems
Team

**Gunhild Court Garage Forecourts
Schedule 2 - Plan No. 120**

© Crown copyright and database right 2018. Ordnance Survey Licence number 100019730.

| | |
|---------------------|---------------------------|
| Date: | 23/01/18 |
| Produced by: | Steve Udall |
| Section/Department: | Informations Systems Team |
| Scale: | 1:500 @ A4 |

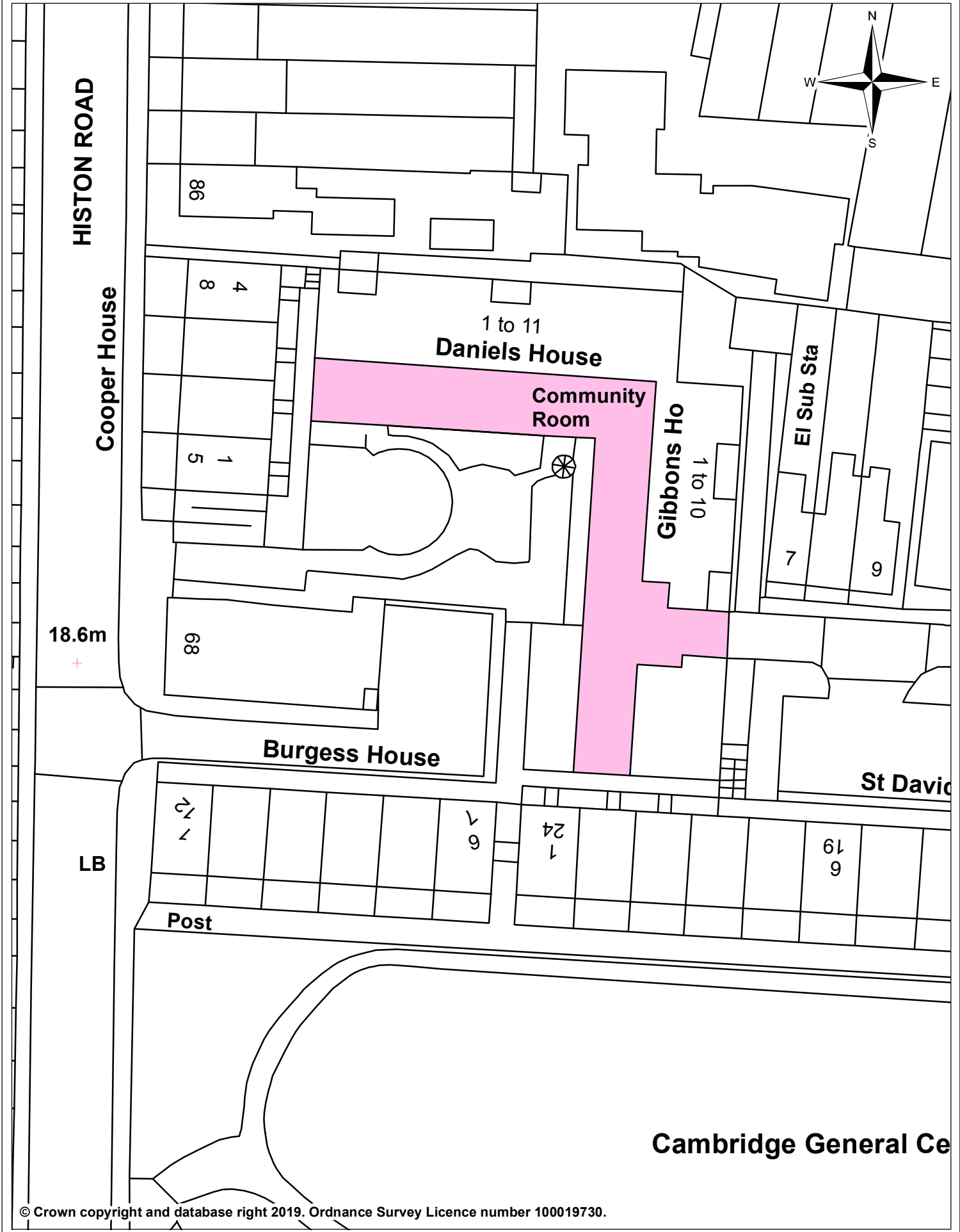

© Crown copyright and database right 2019. Ordnance Survey Licence number 100019730.



**Bermuda Road Garages Forecourt
Schedule 10 Plan No. 121**

| | |
|---------------------|---------------------------|
| Date: | 14 February 2019 |
| Produced by: | 3C Shared Services |
| Section/Department: | Spatial Team |
| Scale: | 1:500 @ A4 |