

1. Tree Felling and Initial Surgery (Existing Site Plan)

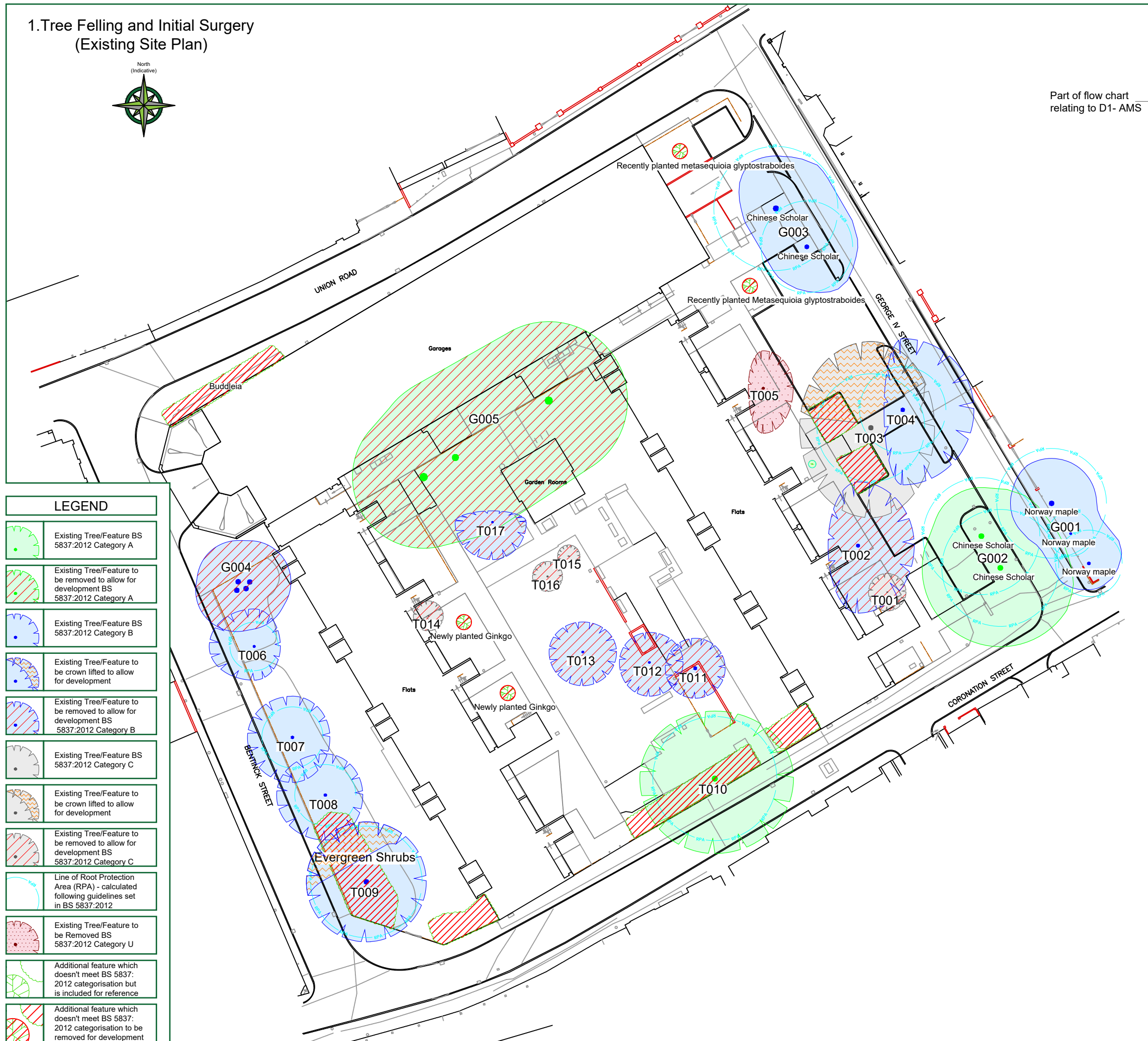

LEGEND	
	Existing Tree/Feature BS 5837:2012 Category A
	Existing Tree/Feature to be removed to allow for development BS 5837:2012 Category A
	Existing Tree/Feature BS 5837:2012 Category B
	Existing Tree/Feature to be crown lifted to allow for development
	Existing Tree/Feature to be removed to allow for development BS 5837:2012 Category B
	Existing Tree/Feature BS 5837:2012 Category C
	Existing Tree/Feature to be crown lifted to allow for development
	Existing Tree/Feature to be removed to allow for development BS 5837:2012 Category C
	Line of Root Protection Area (RPA) - calculated following guidelines set in BS 5837:2012
	Existing Tree/Feature to be Removed BS 5837:2012 Category U
	Additional feature which doesn't meet BS 5837:2012 categorisation but is included for reference
	Additional feature which doesn't meet BS 5837:2012 categorisation to be removed for development

Part of flow chart relating to D1- AMS

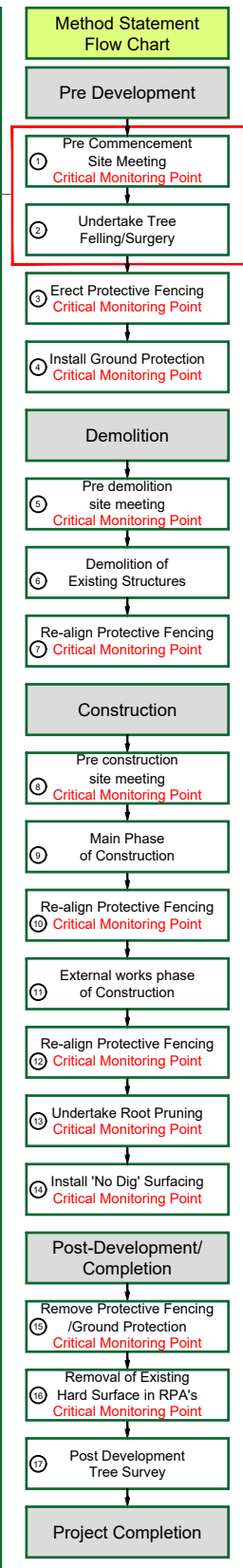

TREE PROTECTION STATUS

Hayden's sourced TPO & Conservation Area status from the Local Planning Authority's Online Mapping System on 31/03/2025.

We were informed that:

- No TPO's are present on site
- The site is located within a conservation area

We would advise it prudent that before any tree work commences, this is checked directly with the Local Planning Authority to confirm that their online mapping system is definitive.

CATEGORY AND DEFINITION

Trees unsuitable for retention	
Category U	Those in such condition that they cannot realistically be retained as living trees in the current land use for longer than 10 years
Trees to be considered for retention	
Category A	Trees of high quality with an estimated remaining life expectancy of at least 40 years
Category B	Trees of moderate quality with an estimated remaining life expectancy of at least 20 years
Category C	Trees of low quality with an estimated remaining life expectancy of at least 10 years, or young trees with a stem diameter below 150mm

NOTE:

Hayden's Arboricultural Consultants were provided with a Topographical Survey but these do not always show the positions of all the trees/features on site. The locations of any additional features have been fixed using GPS. As such the position of the trees/landscape features should not be taken as exact but gives a fair distribution of their locations on site.

Rev.	Date	By	Revision
A	27/04/26	GM	Changes made to drawing
-	23/03/26	GM	Based on Randall Surveys drg. no 16581/GN/1

The position, condition, and dimensions of the trees are based on a site survey undertaken on 18/03/25

"The original of this drawing was produced in colour - a monochrome copy should not be relied upon"

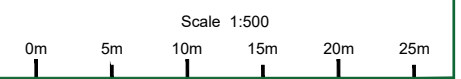

© HAYDEN'S 2025

5 Moseleys Farm Business Centre,
Fornham All Saints,
Bury St Edmunds,
Suffolk, IP28 6JY.

Head Office: 01284 765391
Southern Office: 01722 657423
www.treesurveys.co.uk Email: info@treesurveys.co.uk

Client:	Hill Partnerships Ltd	Drawing Title:	AMS & TPP (Drawing 1)
Site:	Hanover & Princess Court, Bentinck Street, Cambridge, CB2 1HG		
Date:	27/04/26	Drawn By:	GM
Scale:	1:500 (A3)	Checked By:	AG
		Drawing No.:	12318-D1-AMS
		Rev.:	A

2. Demolition of Structures (1st Phase of Tree Protection)

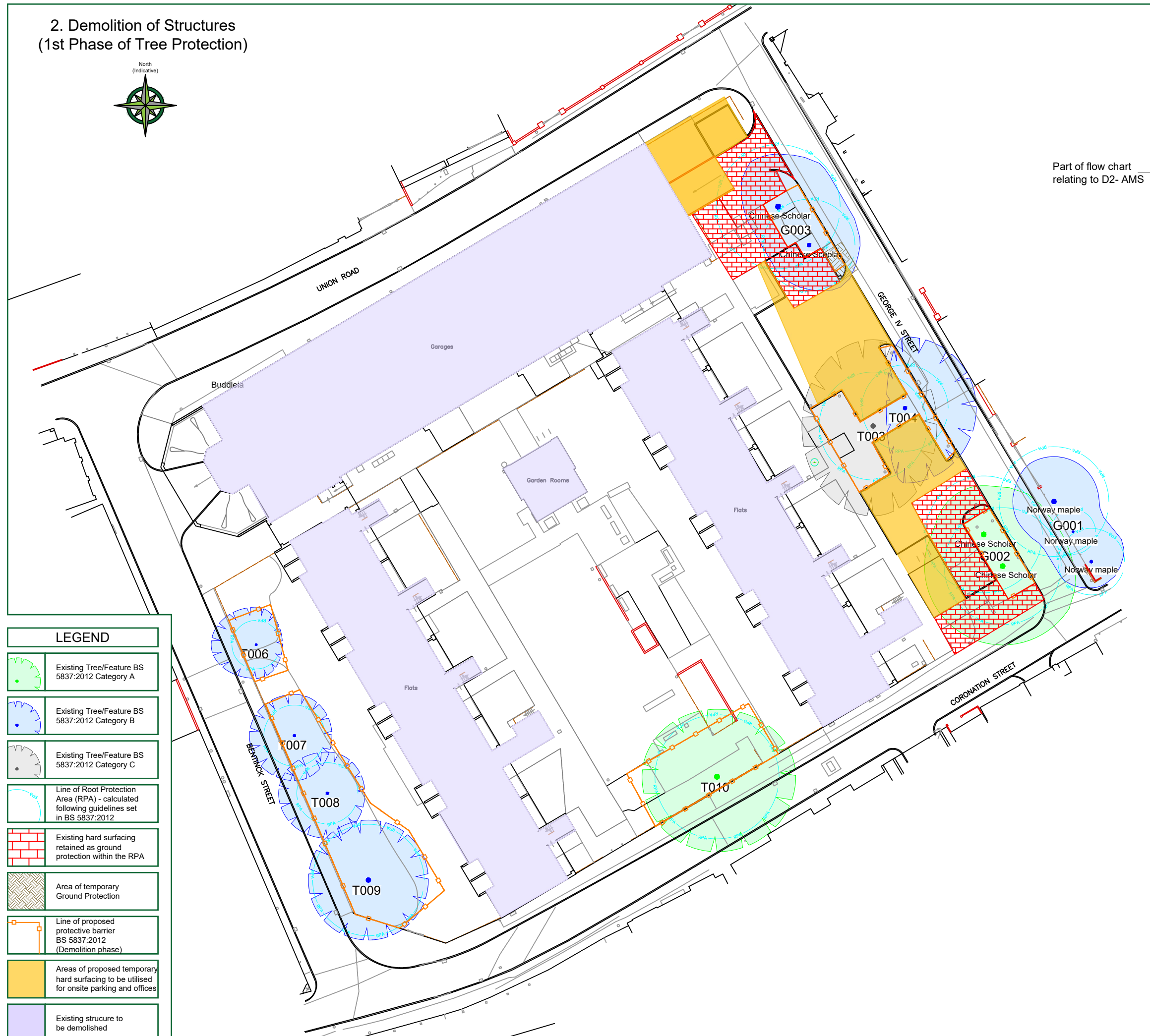

Part of flow chart relating to D2- AMS

LEGEND	
	Existing Tree/Feature BS 5837:2012 Category A
	Existing Tree/Feature BS 5837:2012 Category B
	Existing Tree/Feature BS 5837:2012 Category C
	Line of Root Protection Area (RPA) - calculated following guidelines set in BS 5837:2012
	Existing hard surfacing retained as ground protection within the RPA
	Area of temporary Ground Protection
	Line of proposed protective barrier BS 5837:2012 (Demolition phase)
	Areas of proposed temporary hard surfacing to be utilised for onsite parking and offices
	Existing structure to be demolished

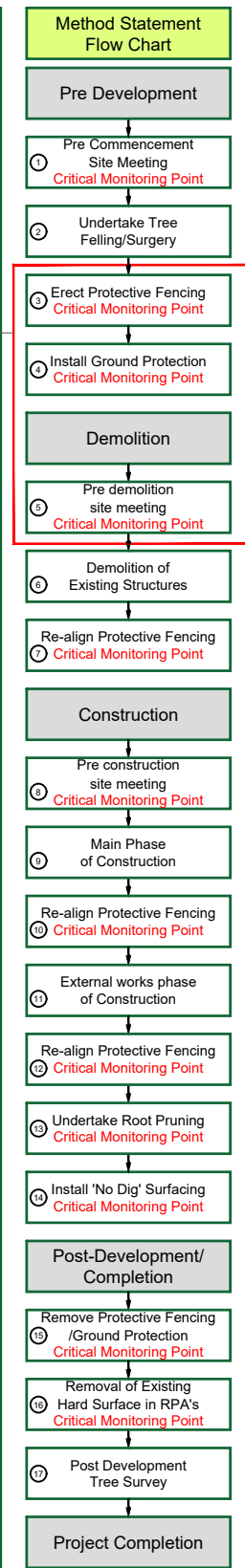

TREE PROTECTION STATUS

Hayden's sourced TPO & Conservation Area status from the Local Planning Authority's Online Mapping System on 31/03/2025.
We were informed that:

- No TPO's are present on site
- The site is located within a conservation area

We would advise it prudent that before any tree work commences, this is checked directly with the Local Planning Authority to confirm that their online mapping system is definitive.

CATEGORY AND DEFINITION

Trees unsuitable for retention	
Category U	Those in such condition that they cannot realistically be retained as living trees in the current land use for longer than 10 years
Trees to be considered for retention	
Category A	Trees of high quality with an estimated remaining life expectancy of at least 40 years
Category B	Trees of moderate quality with an estimated remaining life expectancy of at least 20 years
Category C	Trees of low quality with an estimated remaining life expectancy of at least 10 years, or young trees with a stem diameter below 150mm

NOTE:

Hayden's Arboricultural Consultants were provided with a Topographical Survey but these do not always show the positions of all the trees/features on site. The locations of any additional features have been fixed using GPS. As such the position of the trees/landscape features should not be taken as exact but gives a fair distribution of their locations on site.

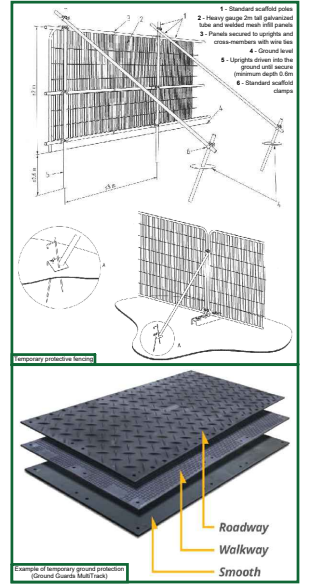

Rev.	Date	By	Revision
A	27/04/26	GM	Changes made to drawing
-	23/03/26	GM	Based on Randall Surveys drg. no 16581/GN/1

The position, condition, and dimensions of the trees are based on a site survey undertaken on 18/03/25
"The original of this drawing was produced in colour - a monochrome copy should not be relied upon"

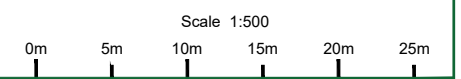

© HAYDEN'S 2025
5 Moseleys Farm Business Centre,
Fornham All Saints,
Bury St Edmunds,
Suffolk, IP28 6JY.
Head Office: 01284 765391
Southern Office: 01722 657423
www.treesurveys.co.uk Email: info@treesurveys.co.uk

Date	Drawn By	Lead File Ref	
27/04/26	GM	ClrPro12318-D-AMS.dwg	
Scale	Checked By	Drawing No.	Rev.
1:500 (A3)	AG	12318-D2-AMS	A

3. Demolition Traffic Management Plan (Informative to 1st Phase of Tree Protection)

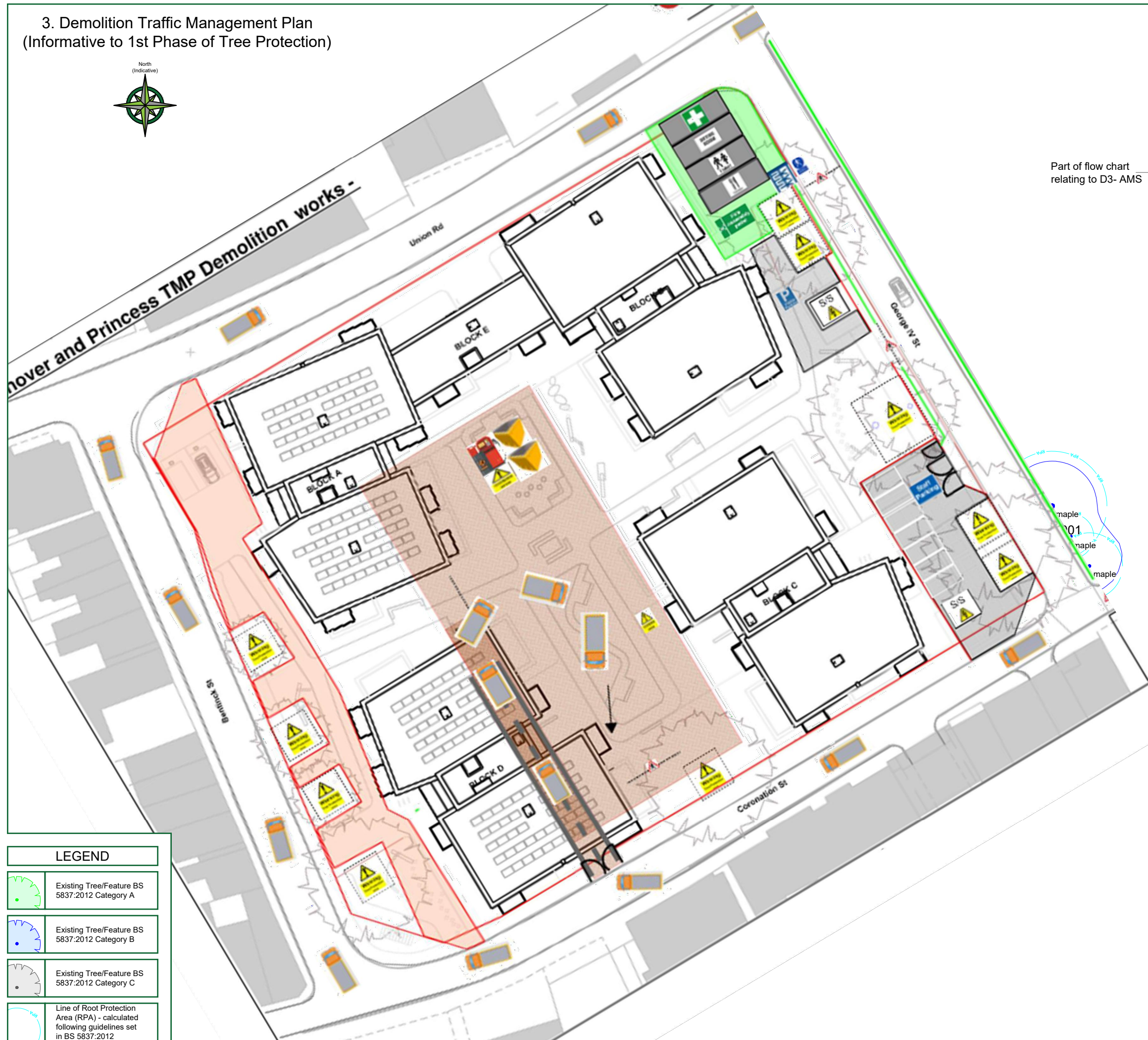

Part of flow chart relating to D3- AMS

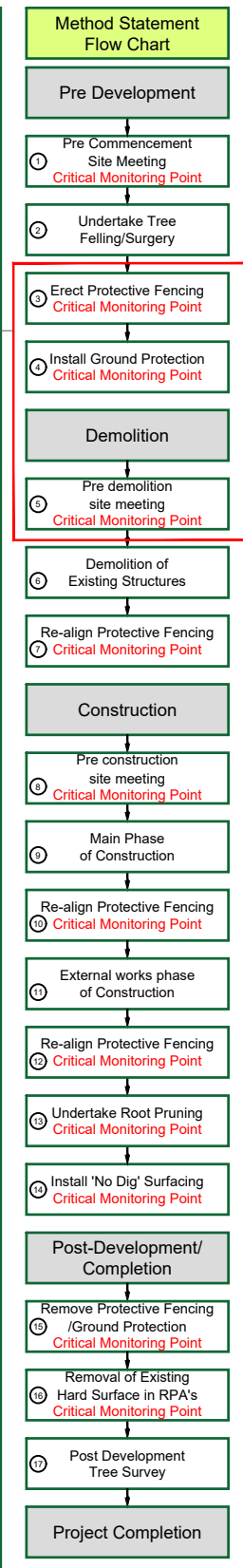

TREE PROTECTION STATUS

Hayden's sourced TPO & Conservation Area status from the Local Planning Authority's Online Mapping System on 31/03/2025.
We were informed that:

- No TPO's are present on site
- The site is located within a conservation area

We would advise it prudent that before any tree work commences, this is checked directly with the Local Planning Authority to confirm that their online mapping system is definitive.

CATEGORY AND DEFINITION

Trees unsuitable for retention	
Category U	Those in such condition that they cannot realistically be retained as living trees in the current land use for longer than 10 years
Trees to be considered for retention	
Category A	Trees of high quality with an estimated remaining life expectancy of at least 40 years
Category B	Trees of moderate quality with an estimated remaining life expectancy of at least 20 years
Category C	Trees of low quality with an estimated remaining life expectancy of at least 10 years, or young trees with a stem diameter below 150mm

NOTE:

Hayden's Arboricultural Consultants were provided with a Topographical Survey but these do not always show the positions of all the trees/features on site. The locations of any additional features have been fixed using GPS. As such the position of the trees/landscape features should not be taken as exact but gives a fair distribution of their locations on site.

Rev.	Date	By	Revision
A	27/04/26	GM	Changes made to drawing
-	23/03/26	GM	Based on Randall Surveys drg. no 16581/GN/1

The position, condition, and dimensions of the trees are based on a site survey undertaken on 18/03/25
"The original of this drawing was produced in colour - a monochrome copy should not be relied upon"

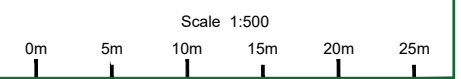

© HAYDEN'S 2025
5 Moseleys Farm Business Centre,
Fornham All Saints,
Bury St Edmunds,
Suffolk, IP28 6JY.
Head Office: 01284 765391
Southern Office: 01722 657423
www.treesurveys.co.uk Email: info@treesurveys.co.uk

Client:	Hill Partnerships Ltd	Drawing Title:	AMS & TPP (Drawing 3)
Site:	Hanover & Princess Court, Bentinck Street, Cambridge, CB2 1HG		
Date:	27/04/26	Drawn By:	GM
Scale:	1:500 (A3)	Checked By:	AG
		Drawn File Ref:	CllPro12318-D-AMS.dwg
		Drawing No.:	12318-D3-AMS
		Rev.:	A

LEGEND	
	Existing Tree/Feature BS 5837:2012 Category A
	Existing Tree/Feature BS 5837:2012 Category B
	Existing Tree/Feature BS 5837:2012 Category C
	Line of Root Protection Area (RPA) - calculated following guidelines set in BS 5837:2012

4. Installation of new Underground Services (2nd Phase of Tree Protection)

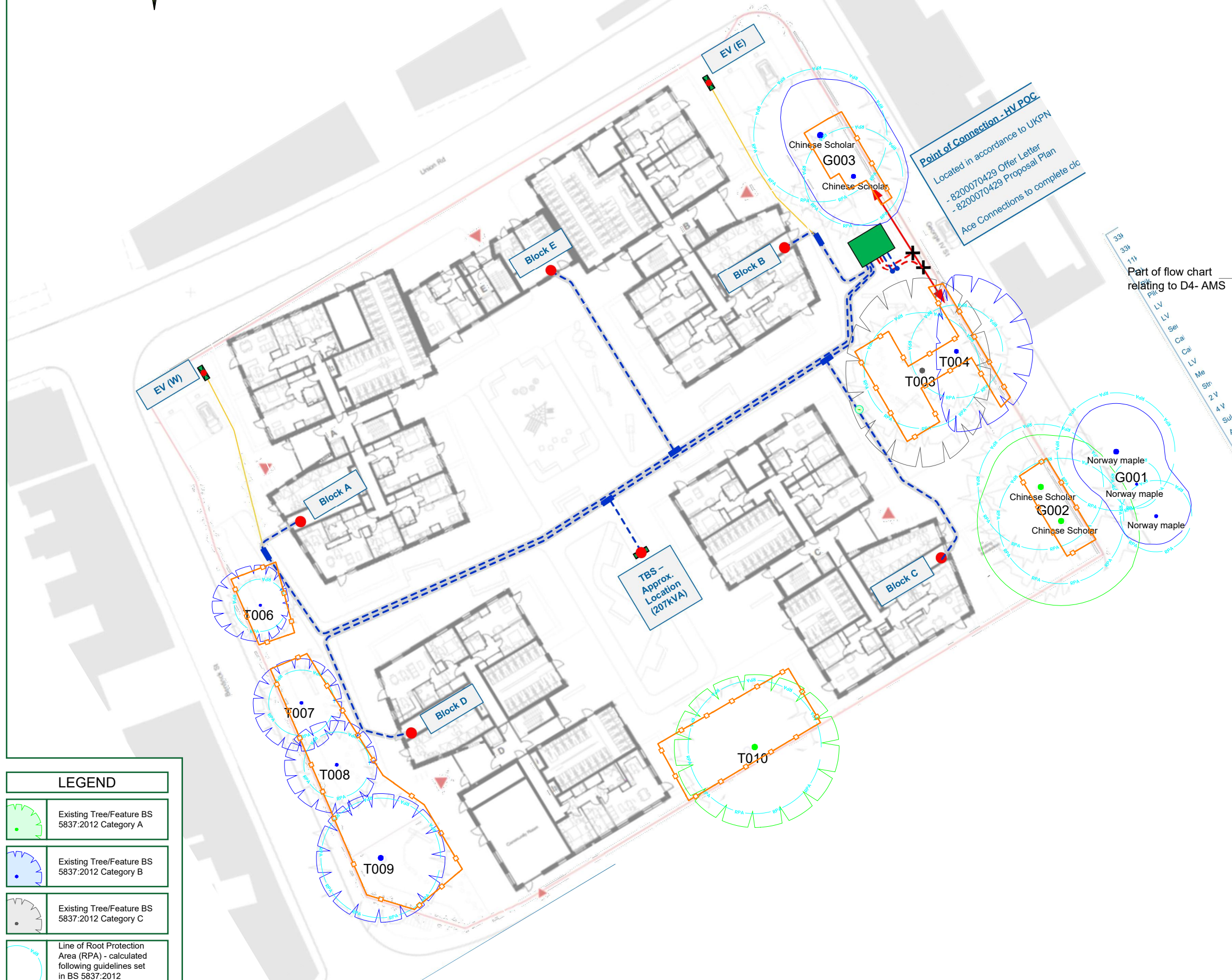

Point of Connection - HV POC
 Located in accordance to Offer Letter
 - 8200070429
 - 8200070429 Proposal Plan
 Ace Connections to complete o/c

Part of flow chart relating to D4- AMS

LEGEND	
	Existing Tree/Feature BS 5837:2012 Category A
	Existing Tree/Feature BS 5837:2012 Category B
	Existing Tree/Feature BS 5837:2012 Category C
	Line of Root Protection Area (RPA) - calculated following guidelines set in BS 5837:2012

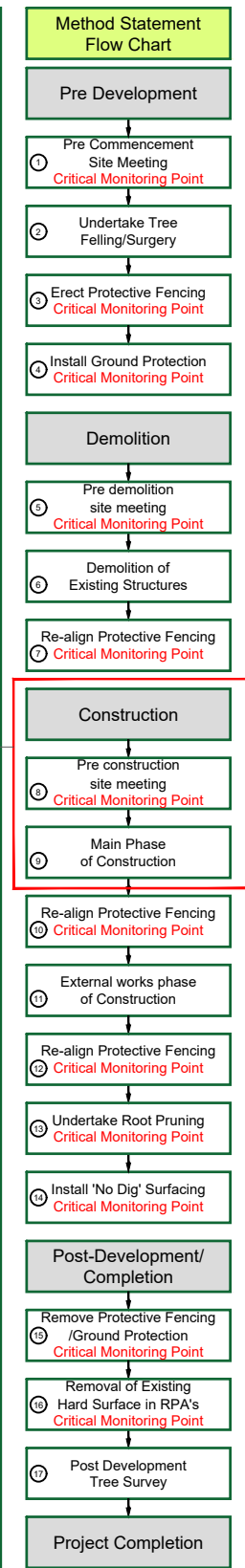

TREE PROTECTION STATUS

Hayden's sourced TPO & Conservation Area status from the Local Planning Authority's Online Mapping System on 31/03/2025.
 We were informed that:

- No TPO's are present on site
- The site is located within a conservation area

We would advise it prudent that before any tree work commences, this is checked directly with the Local Planning Authority to confirm that their online mapping system is definitive.

CATEGORY AND DEFINITION

Trees unsuitable for retention	
Category U	Those in such condition that they cannot realistically be retained as living trees in the current land use for longer than 10 years
Trees to be considered for retention	
Category A	Trees of high quality with an estimated remaining life expectancy of at least 40 years
Category B	Trees of moderate quality with an estimated remaining life expectancy of at least 20 years
Category C	Trees of low quality with an estimated remaining life expectancy of at least 10 years, or young trees with a stem diameter below 150mm

NOTE:

Hayden's Arboricultural Consultants were provided with a Topographical Survey but these do not always show the positions of all the trees/features on site. The locations of any additional features have been fixed using GPS. As such the position of the trees/landscape features should not be taken as exact but gives a fair distribution of their locations on site.

Rev.	Date	By	Revision
A	27/04/26	GM	Changes made to drawing
-	23/03/26	GM	Based on Randall Surveys drg. no 16581/GN/1

The position, condition, and dimensions of the trees are based on a site survey undertaken on 18/03/25
 "The original of this drawing was produced in colour - a monochrome copy should not be relied upon"

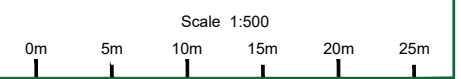

5 Moseleys Farm Business Centre,
 Fornham All Saints,
 Bury St Edmunds,
 Suffolk, IP28 6JY.
 Head Office: 01284 765391
 Southern Office: 01722 657423
 Email: info@treesurveys.co.uk
 www.treesurveys.co.uk

Client:	Hill Partnerships Ltd	Drawing Title:	AMS & TPP (Drawing 4)
Site:	Hanover & Princess Court, Bentinck Street, Cambridge, CB2 1HG		
Date:	27/04/26	Drawn By:	GM
Scale:	1:500 (A3)	Checked By:	AG
		Drawing No.:	12318-D4-AMS
		Rev.:	A

5. Construction of New Structures (3rd Phase of Tree Protection)

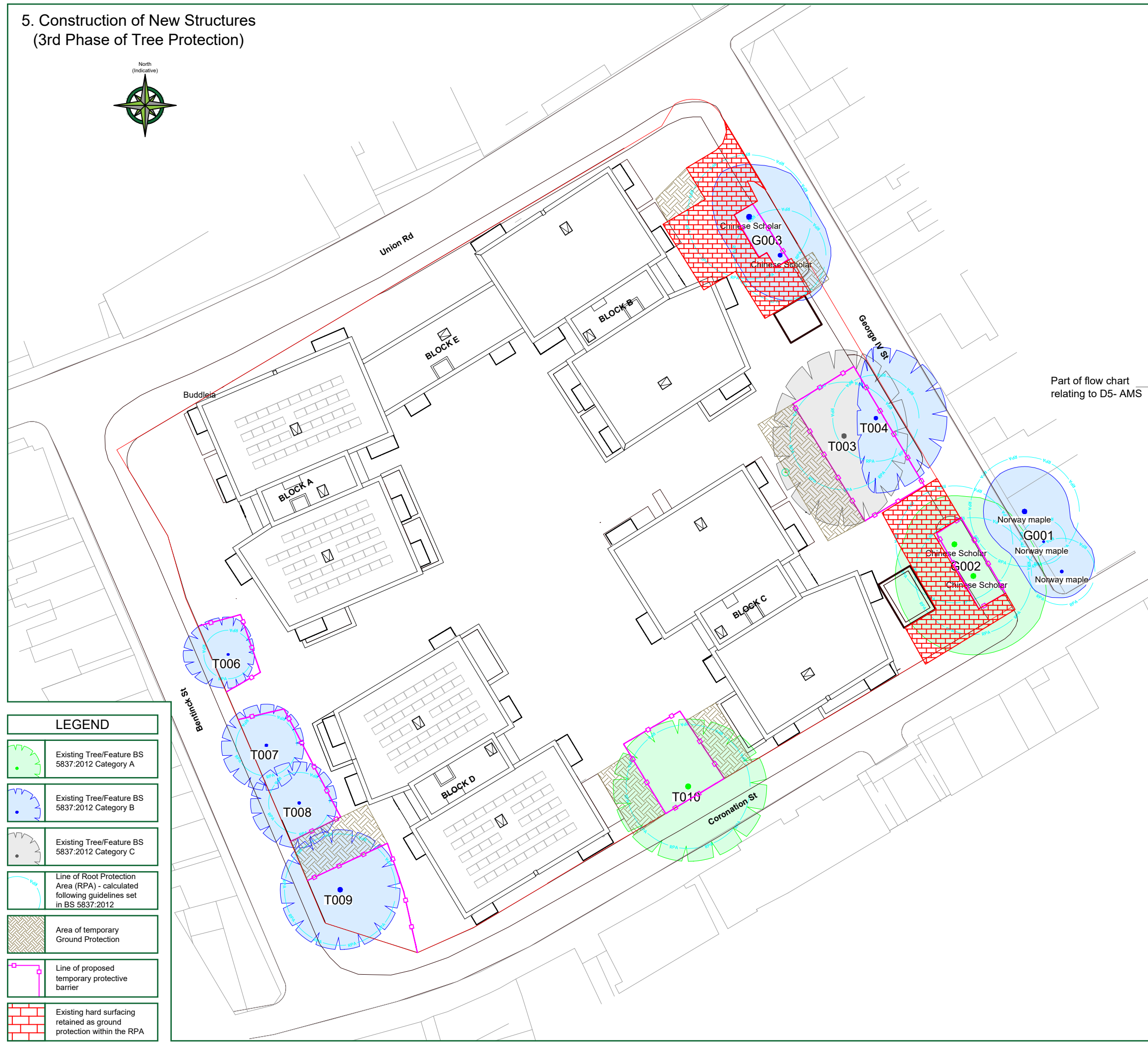

LEGEND	
	Existing Tree/Feature BS 5837:2012 Category A
	Existing Tree/Feature BS 5837:2012 Category B
	Existing Tree/Feature BS 5837:2012 Category C
	Line of Root Protection Area (RPA) - calculated following guidelines set in BS 5837:2012
	Area of temporary Ground Protection
	Line of proposed temporary protective barrier
	Existing hard surfacing retained as ground protection within the RPA

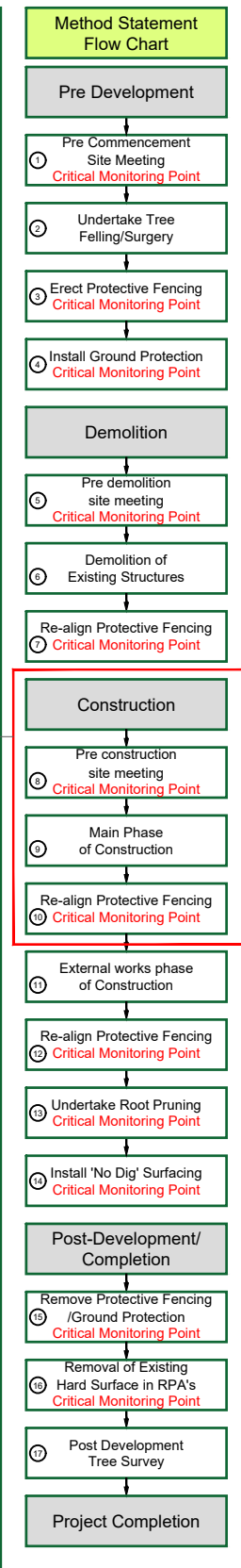

Part of flow chart relating to D5- AMS

TREE PROTECTION STATUS

Hayden's sourced TPO & Conservation Area status from the Local Planning Authority's Online Mapping System on 31/03/2025.
We were informed that:

- No TPO's are present on site
- The site is located within a conservation area

We would advise it prudent that before any tree work commences, this is checked directly with the Local Planning Authority to confirm that their online mapping system is definitive.

CATEGORY AND DEFINITION

Trees unsuitable for retention	
Category U	Those in such condition that they cannot realistically be retained as living trees in the current land use for longer than 10 years
Trees to be considered for retention	
Category A	Trees of high quality with an estimated remaining life expectancy of at least 40 years
Category B	Trees of moderate quality with an estimated remaining life expectancy of at least 20 years
Category C	Trees of low quality with an estimated remaining life expectancy of at least 10 years, or young trees with a stem diameter below 150mm

NOTE:

Hayden's Arboricultural Consultants were provided with a Topographical Survey but these do not always show the positions of all the trees/features on site. The locations of any additional features have been fixed using GPS. As such the position of the trees/landscape features should not be taken as exact but gives a fair distribution of their locations on site.

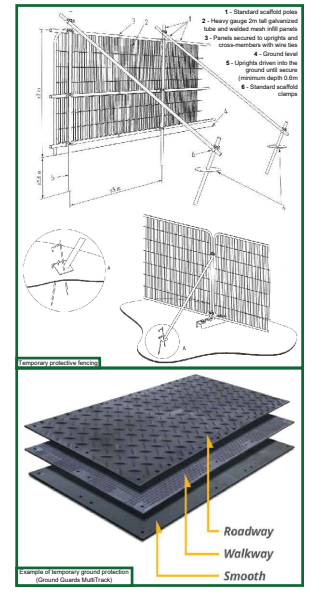

Rev.	Date	By	Revision
A	27/04/26	GM	Changes made to drawing
-	23/03/26	GM	Based on Randall Surveys drg. no 16581/GN/1

The position, condition, and dimensions of the trees are based on a site survey undertaken on 18/03/25
"The original of this drawing was produced in colour - a monochrome copy should not be relied upon"

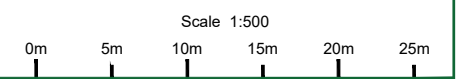

© HAYDEN'S 2025
5 Moseleys Farm Business Centre,
Fornham All Saints,
Bury St Edmunds,
Suffolk, IP28 6JY.
Head Office: 01284 765391
Southern Office: 01722 657423
www.treesurveys.co.uk Email: info@treesurveys.co.uk

Date	Drawn By	Lead File Ref	
24/04/26	GM	ClrPro12318-D-AMS.dwg	
Scale	Checked By	Drawing No.	Rev.
1:500 (A3)	AG	12318-D5-AMS	A

6. Construction of Traffic Management Plan
(Informative to 3rd Phase of Tree Protection)

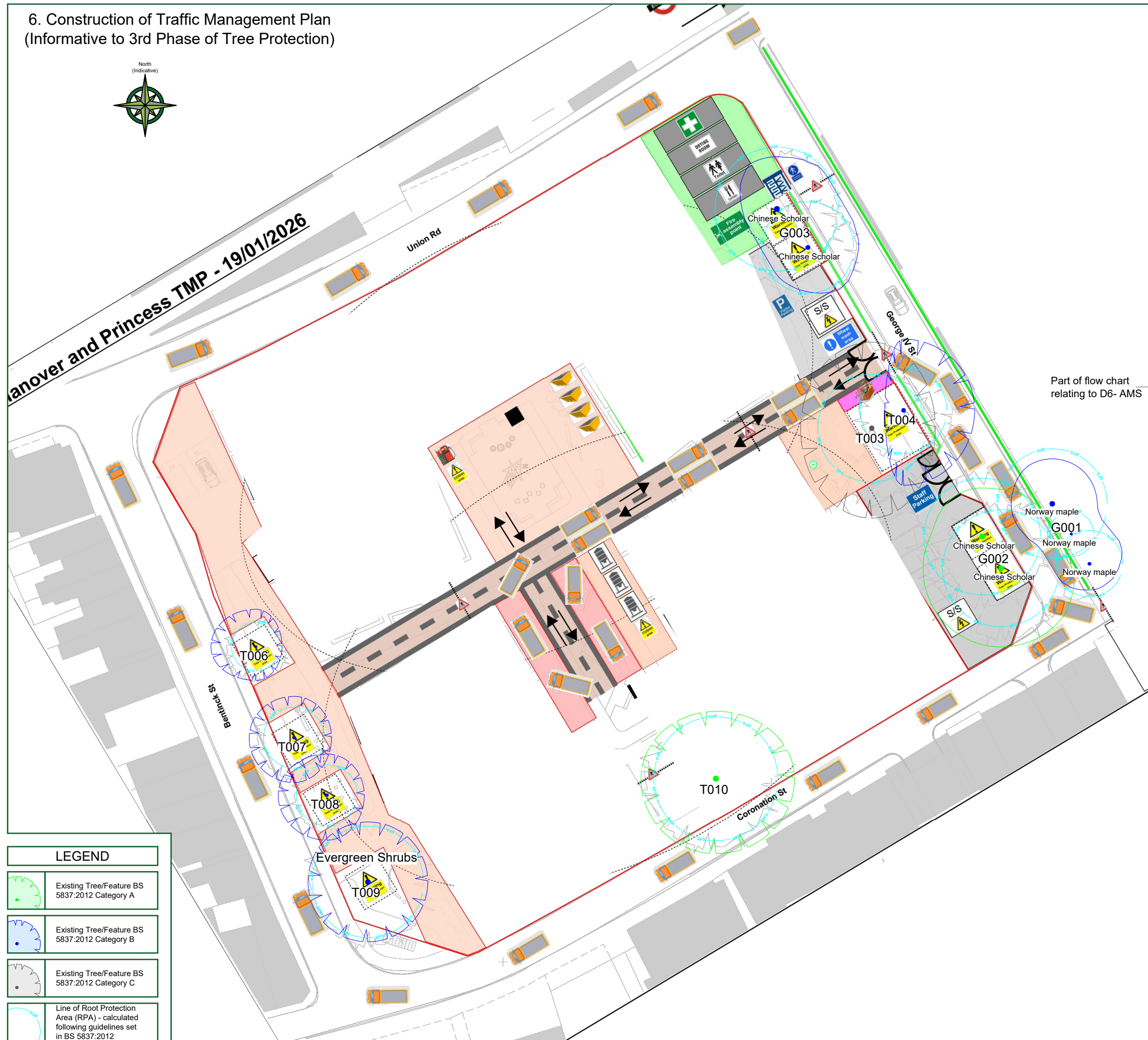

LEGEND	
	Existing Tree/Feature BS 5837:2012 Category A
	Existing Tree/Feature BS 5837:2012 Category B
	Existing Tree/Feature BS 5837:2012 Category C
	Line of Root Protection Area (RPA) - calculated following guidelines set in BS 5837:2012

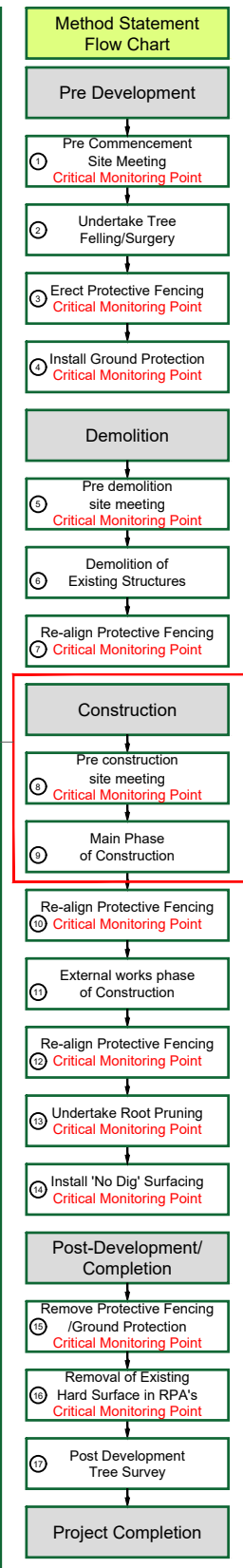

TREE PROTECTION STATUS

Hayden's sourced TPO & Conservation Area status from the Local Planning Authority's Online Mapping System on 31/03/2025.
We were informed that:

- No TPO's are present on site
- The site is located within a conservation area

We would advise it prudent that before any tree work commences, this is checked directly with the Local Planning Authority to confirm that their online mapping system is definitive.

CATEGORY AND DEFINITION

Trees unsuitable for retention	
Category U	Those in such condition that they cannot realistically be retained as living trees in the current land use for longer than 10 years
Trees to be considered for retention	
Category A	Trees of high quality with an estimated remaining life expectancy of at least 40 years
Category B	Trees of moderate quality with an estimated remaining life expectancy of at least 20 years
Category C	Trees of low quality with an estimated remaining life expectancy of at least 10 years, or young trees with a stem diameter below 150mm

NOTE:

Hayden's Arboricultural Consultants were provided with a Topographical Survey but these do not always show the positions of all the trees/features on site. The locations of any additional features have been fixed using GPS. As such the position of the trees/landscape features should not be taken as exact but gives a fair distribution of their locations on site.

Rev.	Date	By	Revision
A	27/04/26	GM	Changes made to drawing
-	23/03/26	GM	Based on Randall Surveys drg. no 16581/GN/1

The position, condition, and dimensions of the trees are based on a site survey undertaken on 18/03/25

"The original of this drawing was produced in colour - a monochrome copy should not be relied upon"

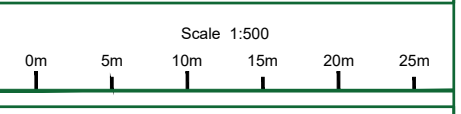

© HAYDEN'S 2025
5 Moseleys Farm Business Centre,
Fornham All Saints,
Bury St Edmunds,
Suffolk, IP28 6JY.
Head Office: 01284 765391
Southern Office: 01722 657423
www.treesurveys.co.uk Email: info@treesurveys.co.uk

Client:	Hill Partnerships Ltd	Drawing Title:	AMS & TPP (Drawing 6)
Site:	Hanover & Princess Court, Bentinck Street, Cambridge, CB2 1HG		
Date:	27/04/26	Drawn By:	GM
Scale:	1:500 (A3)	Checked By:	AG
		Cad File Ref:	C:\Pro\12318-D-AMS.dwg
		Drawing No.:	12318-D6-AMS
		Rev.:	A

7. Removal of Existing Hard Surfaces (2nd Phase of Tree Protection)

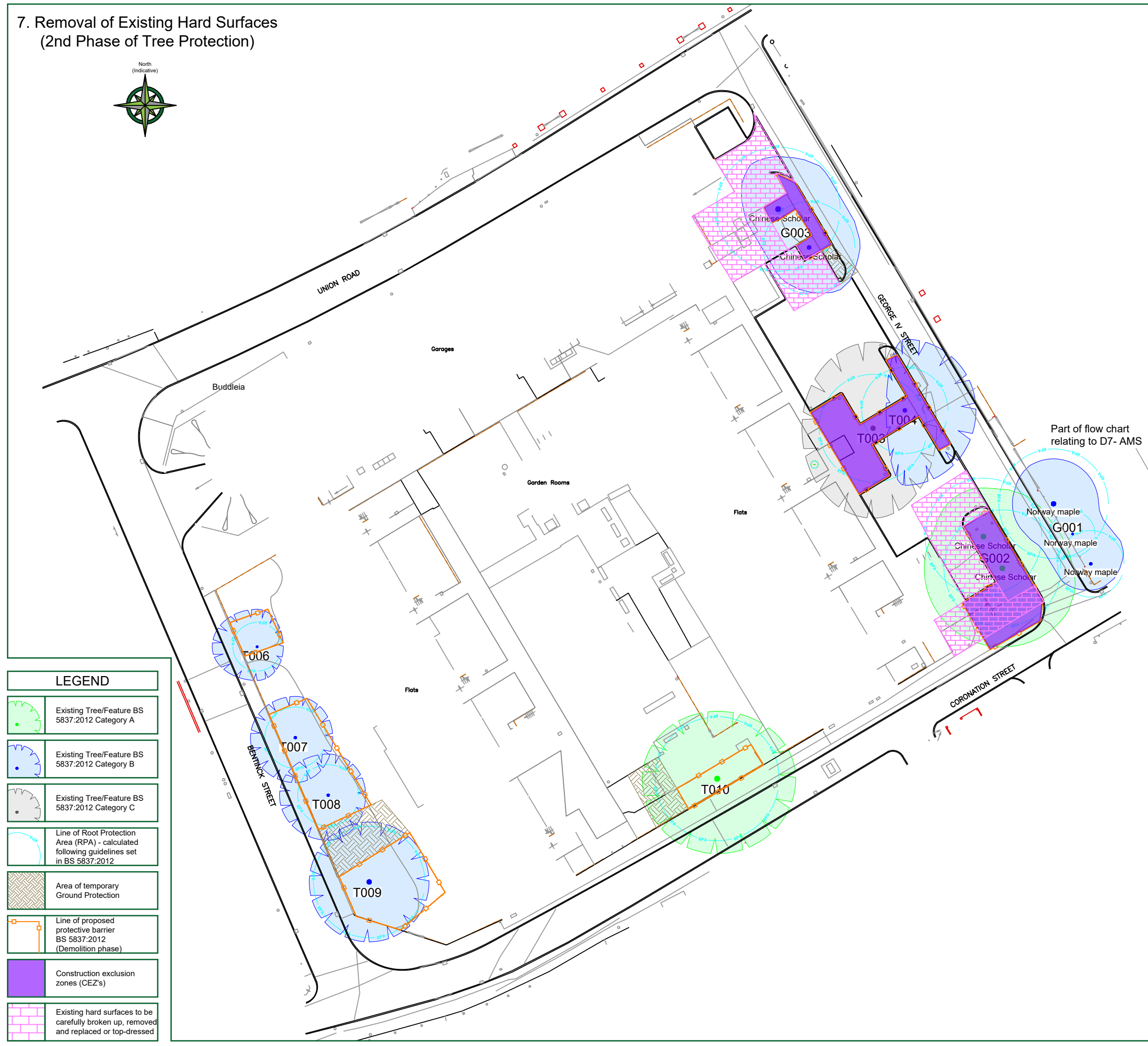

LEGEND	
	Existing Tree/Feature BS 5837:2012 Category A
	Existing Tree/Feature BS 5837:2012 Category B
	Existing Tree/Feature BS 5837:2012 Category C
	Line of Root Protection Area (RPA) - calculated following guidelines set in BS 5837:2012
	Area of temporary Ground Protection
	Line of proposed protective barrier BS 5837:2012 (Demolition phase)
	Construction exclusion zones (CEZ's)
	Existing hard surfaces to be carefully broken up, removed and replaced or top-dressed

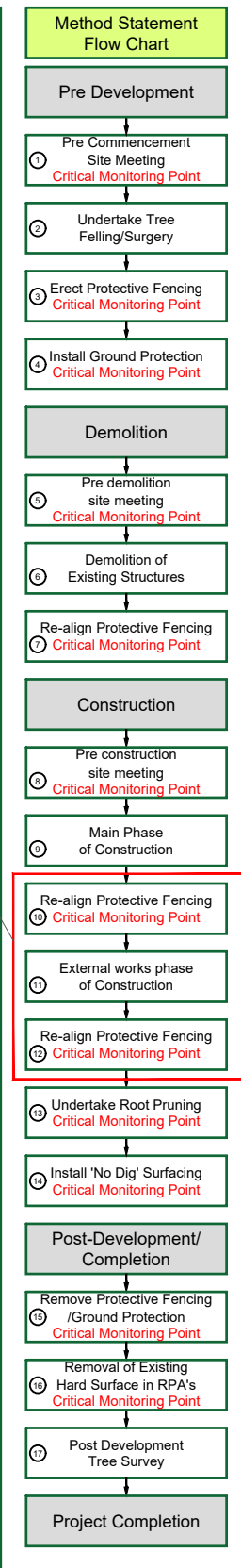

TREE PROTECTION STATUS

Hayden's sourced TPO & Conservation Area status from the Local Planning Authority's Online Mapping System on 31/03/2025.

We were informed that:

- No TPO's are present on site
- The site is located within a conservation area

We would advise it prudent that before any tree work commences, this is checked directly with the Local Planning Authority to confirm that their online mapping system is definitive.

CATEGORY AND DEFINITION

Trees unsuitable for retention	
Category U	Those in such condition that they cannot realistically be retained as living trees in the current land use for longer than 10 years
Trees to be considered for retention	
Category A	Trees of high quality with an estimated remaining life expectancy of at least 40 years
Category B	Trees of moderate quality with an estimated remaining life expectancy of at least 20 years
Category C	Trees of low quality with an estimated remaining life expectancy of at least 10 years, or young trees with a stem diameter below 150mm

NOTE:

Hayden's Arboicultural Consultants were provided with a Topographical Survey but these do not always show the positions of all the trees/features on site. The locations of any additional features have been fixed using GPS. As such the position of the trees/landscape features should not be taken as exact but gives a fair distribution of their locations on site.

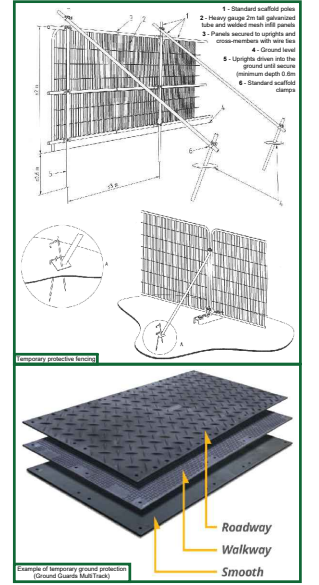

Rev.	Date	By	Revision
A	27/04/26	GM	Changes made to drawing
-	23/03/26	GM	Based on Randall Surveys drg. no 16581/GN/1

The position, condition, and dimensions of the trees are based on a site survey undertaken on 18/03/25

"The original of this drawing was produced in colour - a monochrome copy should not be relied upon"

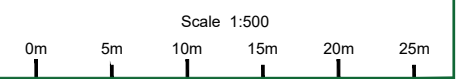

© HAYDEN'S 2025

5 Moseleys Farm Business Centre,
Fornham All Saints,
Bury St Edmunds,
Suffolk, IP28 6JY.

Head Office: 01284 765391
Southern Office: 01722 657423
www.treesurveys.co.uk Email: info@treesurveys.co.uk

Client:	Hill Partnerships Ltd	Drawing Title:	AMS & TPP (Drawing 7)
Site:	Hanover & Princess Court, Bentnck Street, Cambridge, CB2 1HG		
Date:	27/04/26	Drawn By:	GM
Scale:	1:500 (A3)	Checked By:	AG
		Lead File Ref:	ClrPro12318-D-AMS.dwg
		Drawing No.:	12318-D7-AMS
		Rev.:	A

8. Installation of Hard and Soft Landscape (Final Phase of Tree Protection)

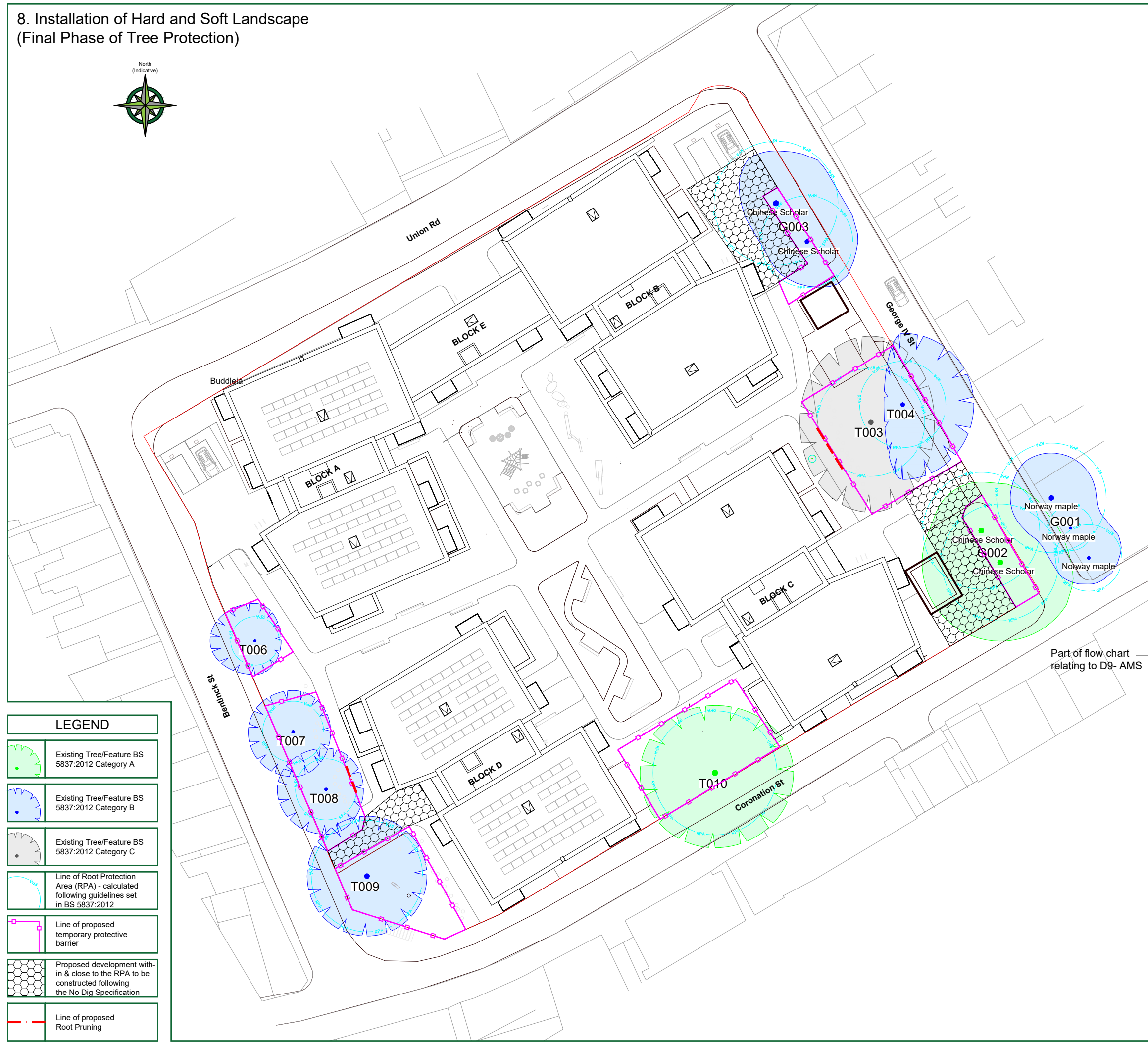

LEGEND	
	Existing Tree/Feature BS 5837:2012 Category A
	Existing Tree/Feature BS 5837:2012 Category B
	Existing Tree/Feature BS 5837:2012 Category C
	Line of Root Protection Area (RPA) - calculated following guidelines set in BS 5837:2012
	Line of proposed temporary protective barrier
	Proposed development within & close to the RPA to be constructed following the No Dig Specification
	Line of proposed Root Pruning

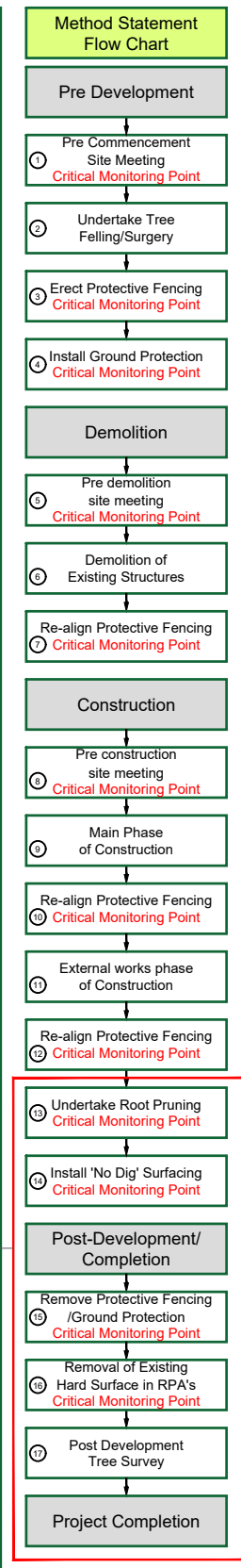

TREE PROTECTION STATUS

Hayden's sourced TPO & Conservation Area status from the Local Planning Authority's Online Mapping System on 31/03/2025.

We were informed that:

- No TPO's are present on site
- The site is located within a conservation area

We would advise it prudent that before any tree work commences, this is checked directly with the Local Planning Authority to confirm that their online mapping system is definitive.

CATEGORY AND DEFINITION

Trees unsuitable for retention	
Category U	Those in such condition that they cannot realistically be retained as living trees in the current land use for longer than 10 years
Trees to be considered for retention	
Category A	Trees of high quality with an estimated remaining life expectancy of at least 40 years
Category B	Trees of moderate quality with an estimated remaining life expectancy of at least 20 years
Category C	Trees of low quality with an estimated remaining life expectancy of at least 10 years, or young trees with a stem diameter below 150mm

NOTE:

Hayden's Arboricultural Consultants were provided with a Topographical Survey but these do not always show the positions of all the trees/features on site. The locations of any additional features have been fixed using GPS. As such the position of the trees/landscape features should not be taken as exact but gives a fair distribution of their locations on site.

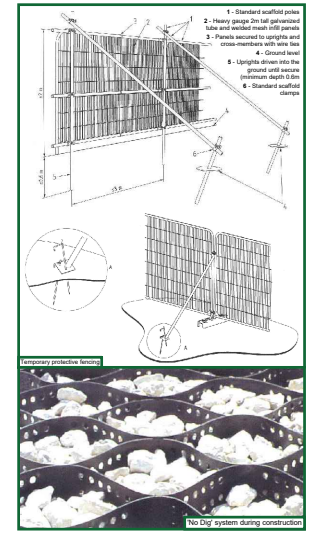

Rev	Date	By	Revision
A	27/04/26	GM	Changes made to drawing
-	23/03/26	GM	Based on Randall Surveys drg. no 16581/GN/1

The position, condition, and dimensions of the trees are based on a site survey undertaken on 18/03/25

"The original of this drawing was produced in colour - a monochrome copy should not be relied upon"

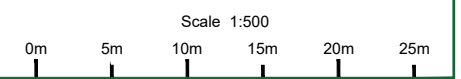

© HAYDEN'S 2025

5 Moseleys Farm Business Centre,
Fornham All Saints,
Bury St Edmunds,
Suffolk, IP28 6JY.

Head Office: 01284 765391
Southern Office: 01722 657423
www.treesurveys.co.uk Email: info@treesurveys.co.uk

Client:	Hill Partnerships Ltd	Drawing Title:	AMS & TPP (Drawing 8)
Site:	Hanover & Princess Court, Bentnck Street, Cambridge, CB2 1HG		
Date:	27/04/26	Drawn By:	GM
Scale:	1:500 (A3)	Checked By:	AG
		File Ref:	ClrPro12318-D-AMS.dwg
		Drawing No.:	12318-D8-AMS
		Rev.:	A