

TOTAL EXTERNAL COVERS: 17no.

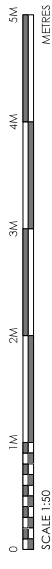

NOTES:

1 CAST IRON LITTER BINS: to Sidney Street

2 REMOVABLE BOLLARD: to Petty Cury

EXTERNAL FURNITURE:

EPOLE ARCHIVOLO CHAIR - 17no.
 Exterior Grade Polypropylene chair
 Dye Green
 1700x600x800mm
 510w x 575d 840h

SUPERSQUARE TABLE - 87no.
 Castor, White & Aluminium
 600w x 600d x 780h

NOTE
 loose tables & chairs
 to be brought inside outside of trading hours



EXAMPLES OF FURNITURE

FOR APPROVAL

PROJECT	wasabi
LOCATION	23-23A PETTY CURY, CAMBRIDGE, CB2 3NB
TITLE	PROPOSED EXTERNAL SEATING LICENCE
DRAWING No.	1 687.5- WAS-01
REVISION	DATE DRAWN SCALE @ A3
1	12.03.21 1:50

All dimensions to be confirmed by the Civil/Structural works to be confirmed by Structural Engineer. All elements to comply with relevant requirements.

Copyright One Red Wall Ltd
 Crownpoint House, 22-24 Crownpoint Rd, Surbiton,
 Surrey, Middlesex, UK. Tel: 020 8979207
 www.oneredwall.com

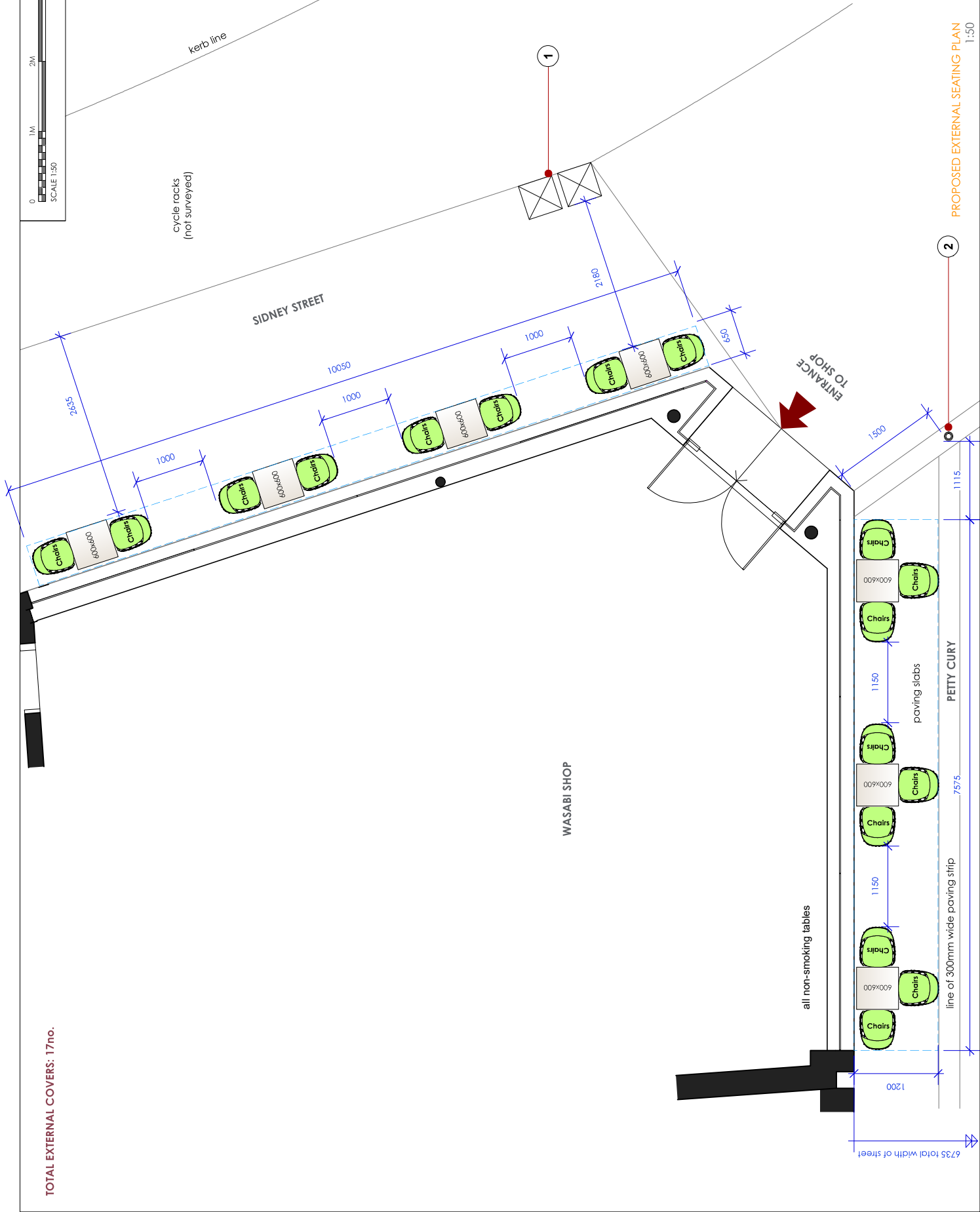

PROPOSED EXTERNAL SEATING PLAN
 1:50